

REV	DATE	BY	DESCRIPTION
H	24-11-2014	TD	DIM 950 (was 1010)
I	5-2-2016	DD	SHELL CHANGED FROM FOLDED INTO ROLLED
J	27-9-2016	DD	SHELL CHANGED, PRODUCT KEY CHANGED

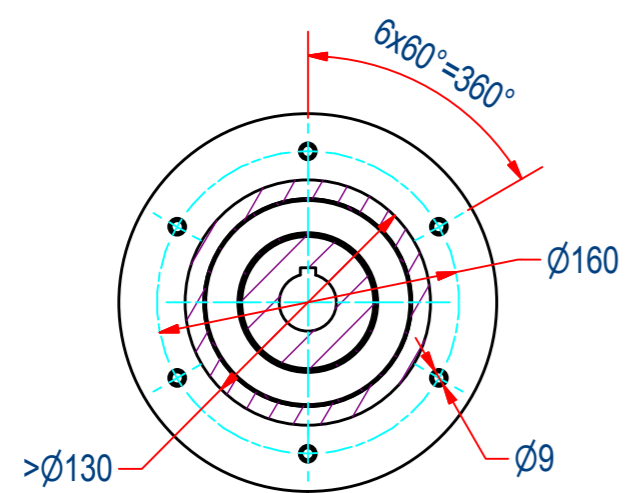

H-H
MOUNTING DETAIL (2x)
HOLE PATTERN COUNTER PART

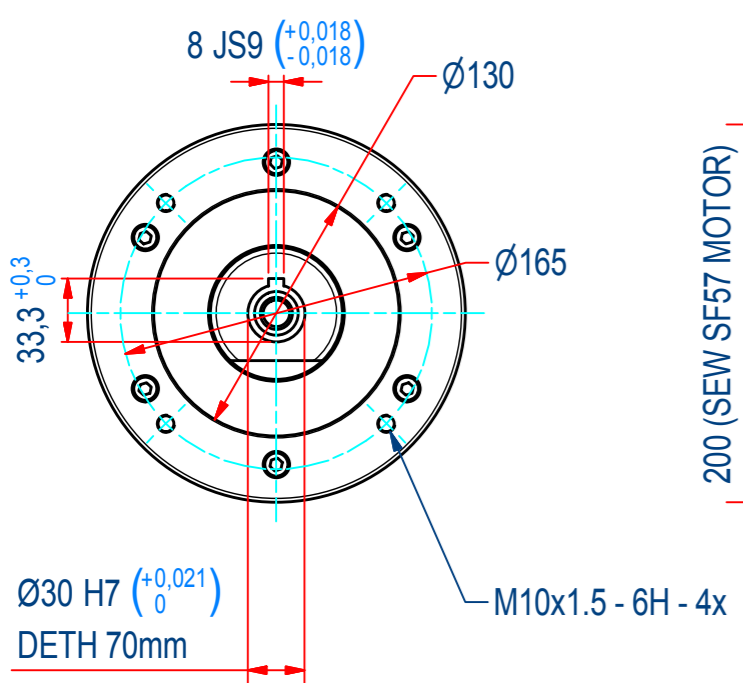
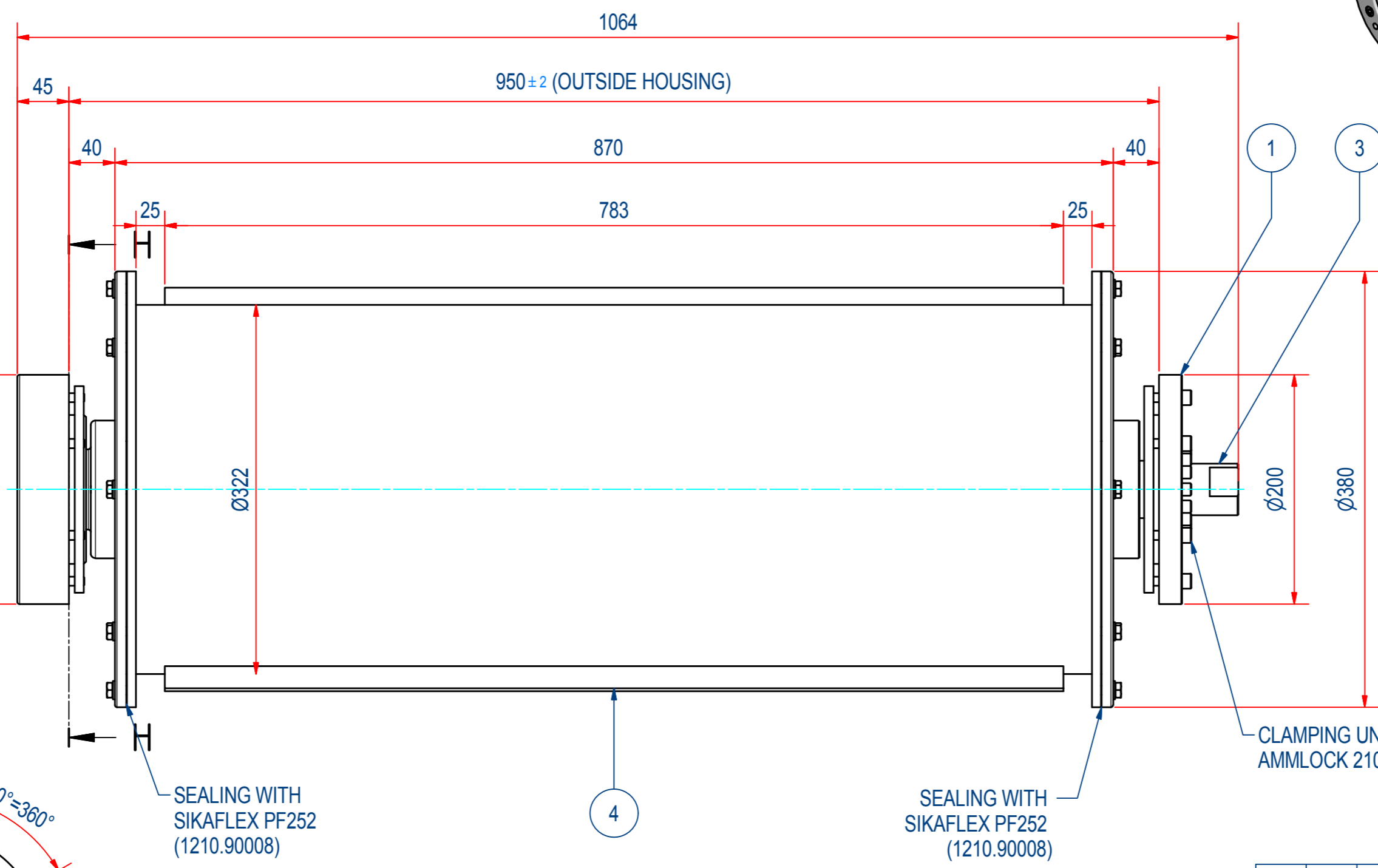
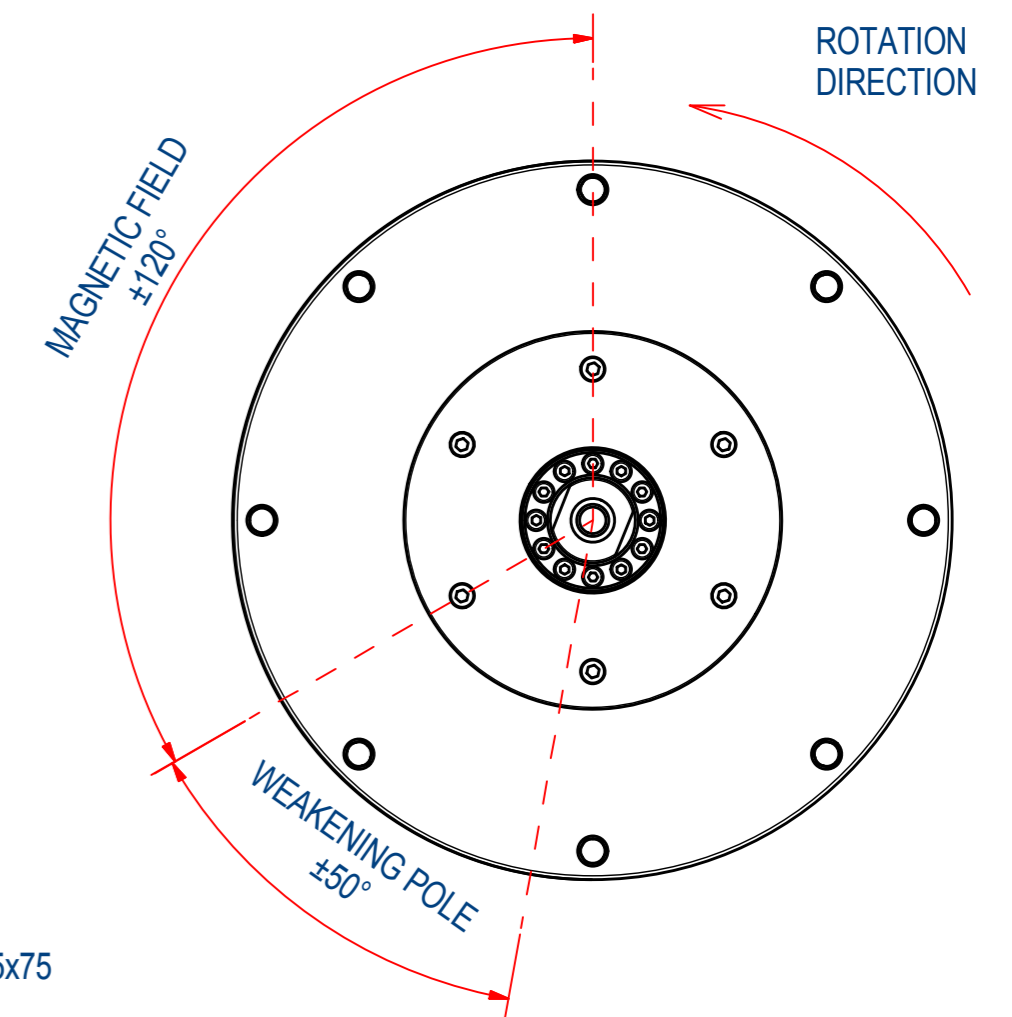

ITEM	QTY	PART NUMBER	DESCRIPTION	Dimensions
4	1	E0047686	SHELL WITH CLEATS RECD 08	
3	1	E0009976	DR-08 AXLE ST	
2	1	E0010243	DR-08-B DRUM ASSY	
1	1	E0011058	DR-00 FLANGE ASSY ALU	

RAW MAT.	QTY	MAT. NUMBER	MAT. DESCRIPTION	LENGTH (mm)	WIDTH (mm)
1					

Sheet: A2	Extra info:	General tolerance: ISO 2768 - cL
Drawn: TD	Weight (kg): 151,8	Drawn according: ISO268; ISO1101; ISO2553
Date: 27-11-2013		Status: Released
Spare part: False		Customer reference number:
Quick search: RMD-08	GOUDSMIT MAGNETIC SYSTEMS	File number: E0010858 Rev: J
Description: RMD-08-32-RN-B-OR-30S2	© All rights reserved. Reproduction is not permitted without written permission of GOUDSMIT Magnetic Systems BV	Part number: E0010858 Rev: J