

Instruction manual for hose reel
To be use with the types listed above

Please retain for future use

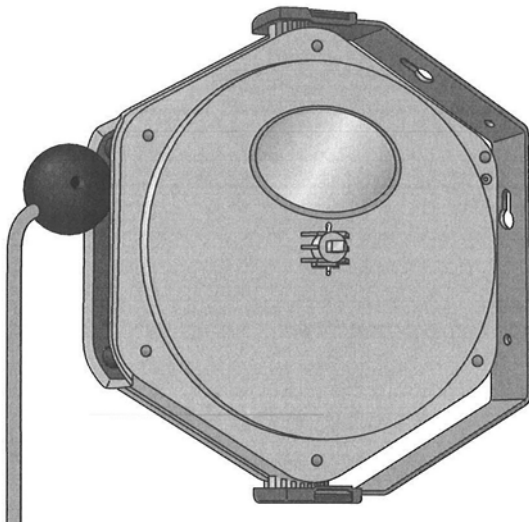

259/50001



259/4000

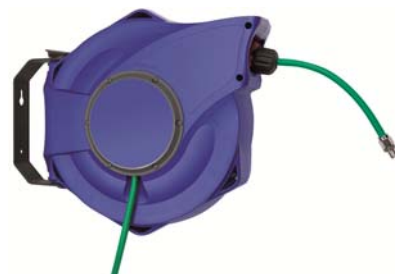

259/4400-1

1. Safety

1.1 Introduction/Description



This cable reel has undergone a function and quality test in accordance with European norms (EN 61242) for electrical installations. The cable reel has a thermal overload protector and live parts are protected with a cover.

A special safety device prevents the spring inside the cable reel from falling out. This safety device must not be removed or modified. Safety devices must **under no circumstances** be removed or modified in any other way.

The cable reel may only be installed or repaired by a qualified technician (e.g. an electrician). When replacing the plug, only a plug approved in accordance with European norms for 230 V/ 16 A may be used.



Read through the user manual carefully before installation or use. The operation, maintenance and service conditions set out in the user manual must be followed strictly.

The spring tension must be released if the cover is removed. The cable reel and the cable must be checked regularly before each use.

Any damage or defects must be repaired immediately. A broken cable must be replaced!



1.2 Operation in accordance with the regulations



The cable reel is only meant to be used in dry areas. It may not be used outdoors or in wet areas.

Arbitrary modifications to the cable reel are forbidden for safety reasons. The cable reel may only be connected to a mains power supply with maximum voltage of ~230 V. The maximum permitted load is:



For a retracted cable: 1000 Watt



For an extended cable: 3500 Watt

Machines/tools connected to the cable reel must not exceed the maximum permitted output for the cable reel. Take care that the connected tools do not damage the cable. Only use flawless and tested tools suitable for the task.

1.3 Risks during handling and service



DANGER!

Contact with live parts means there is a danger of death. Never open the cable reel when it is connected to the mains. The power supply must always be disconnected before service or repairs.



Protect the cable so that it is not damaged by sharp or hot objects and ensure that it is kept clear of an open flame as this can damage the insulation.

2. Installation

2.1 Introduction



The cable reel may only be connected to the mains by a qualified technician. The cable reel may only be used in dry areas. The mains voltage must not exceed ~230 V or have a fuse higher than 16 A. Follow the specific national installation regulations.

2.2 Assembly

1



2

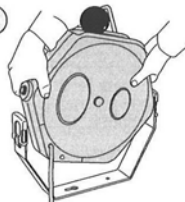

3

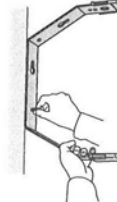

4

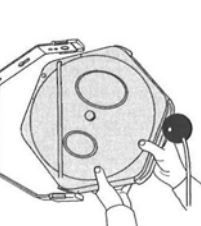

5

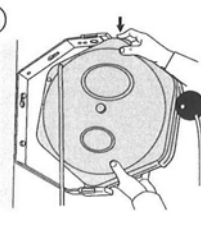

6

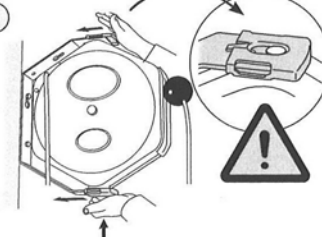

2.3 Wall, column or ceiling mounting

The cable reel's wall bracket must be mounted on a stable wall etc. with two screws (Ø 8 x 40 mm or longer).

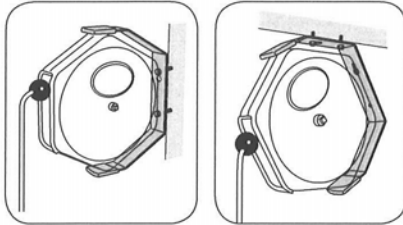

2.4 Cable length, unretractable

The unretractable cable length is 1 (SE) and 2 (LE) metres. If it needs to be shortened, do not under any circumstances move the stop ball as this can lead to problems when retracting the cable.

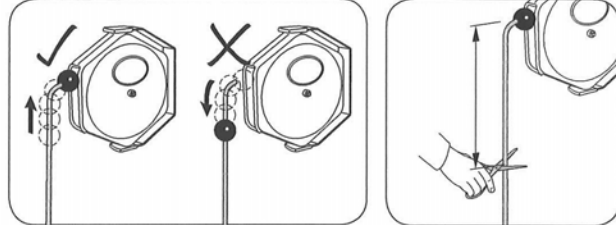

2.5 Connection to the mains power supply

1. Mount the cable reel in the desired position.
2. If necessary, fit a suitable plug (230 V/16 A) to the 1 metre long connection cable (3x1.5 mm²).

Technical data

Type:	SE-10	LE-17
Cable (Type H07RN-F):	10 m. (3x1.5 mm ²)	17 m. (3x1.5 mm ²)
Connection voltage:	~230 volt	~230 volt
Maximum load: (retracted)	1000 Watt / 4 A	1000 Watt / 4 A
Maximum load: (extended)	3500 Watt / 16 A	3500 Watt / 16 A
Degree of protection:	IP 23	IP 23
Operating temperature:	+5°C to +60°C	+5°C to +60°C
Weight:	4.6 kg	6.7 kg
Certificate:	CE	CE

3. Operation

3.1 Pulling out the cable

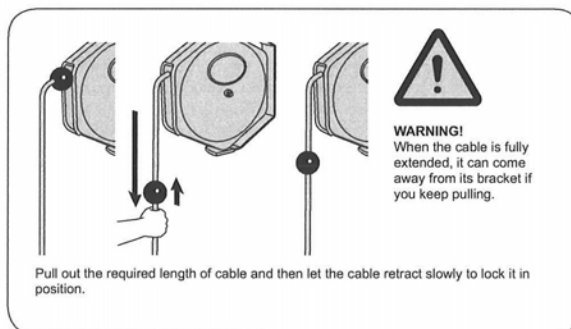

3.2 Retracting the cable

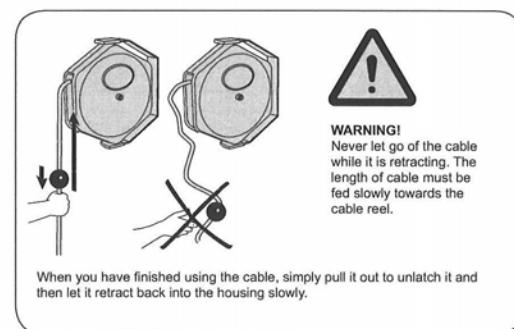

3.3 Adjusting the spring tension

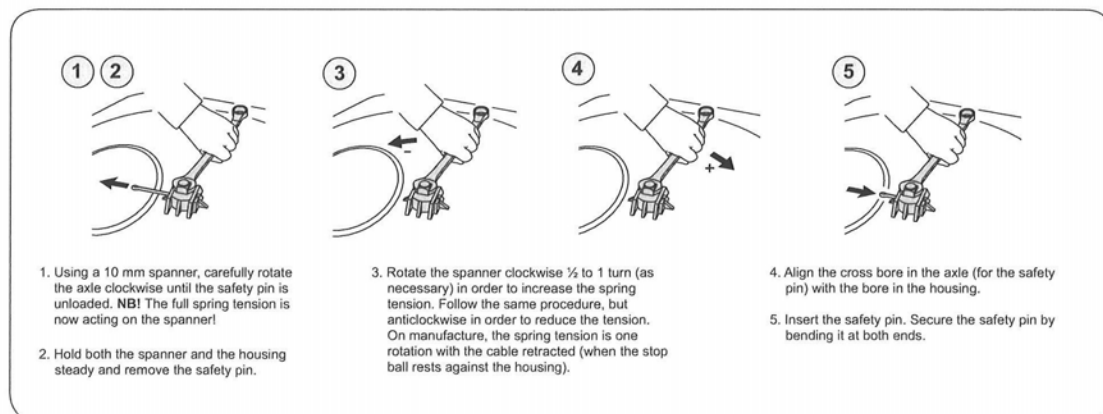

3.4 Freewheel action (SE reels only)

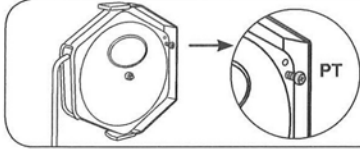

1. Pull out the cable until the noise from the snap-in locking mechanism stops.
2. Release the cable for about 10-20 cm and secure with the PT screw supplied.
3. Pull out the cable. The snap-in locking mechanism is now deactivated.

4. Malfunction/action

4.1 The connected tool does not start

Make sure that the cable reel is connected to the mains. Check that all fuses are intact. When the fuse is disabled, you should make sure that both the cable and the connected tool are intact. Disconnect the live device/tool from the cable reel before you screw the old fuse into place or replace it with a new one. If the fuse is intact, it is probably the heat-sensitive overload protection which has turned off the power supply to the cable reel.

Make sure that the connected tool is not overloading the cable reel. Before you turn the power supply back on, the live device/tool must be disconnected from the cable reel. Once the cable reel has cooled down, after about five minutes, you can press the reset button.

4.2 The connected tool suddenly switches off and cannot be restarted

Check that all fuses are intact. If the fuse was disabled, you should make sure that nothing is wrong with the tool or cable reel (e.g. short circuit). Disconnect the live device/tool from the cable reel before you screw the old fuse into place or replace it with a new one. If the fuse is intact, it is probably the heat-sensitive overload protection which has turned off the power supply to the cable reel. Make sure that the connected tool is not overloading the cable reel.

Before you turn the power supply back on, the live device/tool must be disconnected from the cable reel. Once the cable reel has cooled down, after about five minutes, you can press the reset button.

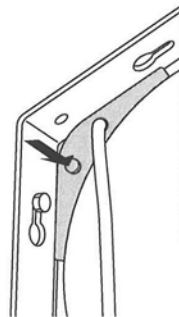

4.3 The cable cannot be fully retracted

Make sure that the latch has released. Check that the stop ball has not been displaced. If necessary the spring tension must be adjusted. Follow the instructions (section 3.3).

4.4 The problem cannot be resolved by following the steps above

Get a qualified technician to inspect the cable reel and the installation. Take the cable reel to your retailer for examination and inspection.

5. Maintenance



Carry out regular checks that there are no problems with the cable, housing or protective device. Any damage or defects must be repaired immediately. Only a qualified technician may replace a cable or reel fitted with a spring cassette. Only original spare parts must be used!



DANGER!!
Contact with live parts means there is a danger of death. Never open the cable reel when it is connected to the mains. The power supply must always be disconnected before service or repairs.

6. Disposal/Recycling



IMPORTANT!
Help us to take care of the environment. When disposing of the cable reel, please do so in accordance with local environmental regulations.

7. Warranty

CEJN AB provides a two (2) year warranty from the date of manufacture. Contact your retailer concerning warranty enquiries.

8. Spare parts

For safety reasons, only original spare parts must be used. See the last page of this user manual for a list of spare parts or contact your retailer.

Applies to the following articles:

Hose reel for compressed air

Article No.	Type No.
113961 // replaced by 152313	259/5120 // 259/5120-1
113962 // replaced by 152310	259/5100 // 259/5100-1
113963 // replaced by 152314	259/5000 // 259/5000-1
113964 // replaced by 152315	259/4900 // 259/4900-1

Hose reel for compressed air, high flow capacity

Article No.	Type No.
113965	259/4000

Hose reel for compressed air, anti-spark

Article No.	Type No.
136360	259/5130

Hose reel for water

Article No.	Type No.
113966	259/4400