

Applications: Water (no steam), neutral and non-corrosive liquid media, mineral oils.  
 Only suitable for liquid media. Flap valve closes by gravity, therefore only possible to be installed horizontally!

Operating temperature	-10 °C to 80 °C
Housing	Red brass
Valve disc	Brass
Max. Operating pressure	16 bar
Standard thread	G-thread acc. to DIN EN ISO 228-1

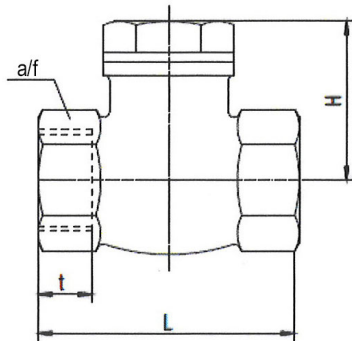

RK12RG

### Check valve metallic sealing, red brass

Art. No.	Type No.	Thread	DN	a/f mm	L mm	H mm	t mm
158073	RK12RG	G 1/2	15	27	60.0	40.0	12.0
158074	RK34RG	G 3/4	20	34	70.0	49.0	13.0
158075	RK1RG	G 1	25	41	80.0	56.0	15.0
158076	RK114RG	G 1 1/4	32	51	95.0	60.0	16.0
158077	RK112RG	G 1 1/2	40	55	105.0	70.0	18.0
158078	RK2RG	G 2	50	70	130.0	80.0	20.0
158079	RK212RG	G 2 1/2	65	90	160.0	105.0	20.0

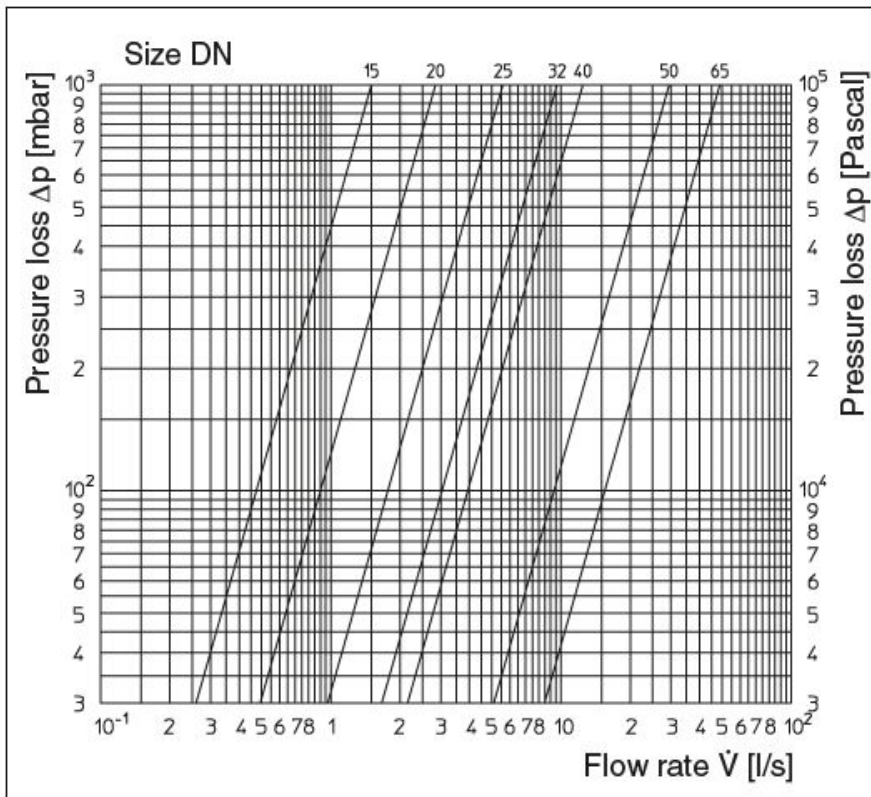

Flow chart