

Acc. to DIN EN 10242 (formerly DIN 2950).

The classic - and the most popular - screw fitting series for pipe construction.

These fittings are characterized by their high mechanical strength and surface quality to DIN 2444. They are completely coated with a layer of pure zinc and are therefore suitable for drinking water; they are also protected against rust.

The fittings are used in pipe construction, plumbing and gas installations as well as a wide range of industrial applications.

Working minimal temperature = -20 °C; 25 bar.

Working pressure for temperature range from -20 °C to 120 °C = 25 bar.

Working pressure for temperature range from 120 °C to 300 °C = 20-25 bar

Products with flat seal have a recommended temperature of -20 °C to 200 °C with working pressure of max. 25 bar.

Material: Black malleable iron B350-10, design symbol A
 Temperature range: -20 °C to +300 °C
 Surface: Hot dip galvanised
 Standard thread: acc. ISO 7-1

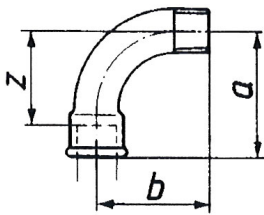

TFB 1-12

Long sweep bend 1, 90°, female/male

Type No.	Art. No.	Thread female	Thread male	a mm	b mm	z mm
TFB 1-14	112826	Rp 1/4	R 1/4	40.0	36.0	30.0
TFB 1-38	112827	Rp 3/8	R 3/8	48.0	42.0	38.0
TFB 1-12	112828	Rp 1/2	R 1/2	55.0	48.0	42.0
TFB 1-34	112829	Rp 3/4	R 3/4	69.0	60.0	54.0
TFB 1-10	112830	Rp 1	R 1	85.0	75.0	68.0
TFB 1-114	112831	Rp 1 1/4	R 1 1/4	105.0	95.0	86.0
TFB 1-112	112832	Rp 1 1/2	R 1 1/2	116.0	105.0	97.0
TFB 1-20	112833	Rp 2	R 2	140.0	130.0	116.0
TFB 1-212	112834	Rp 2 1/2	R 2 1/2	176.0	165.0	149.0
TFB 1-30	112835	Rp 3	R 3	205.0	190.0	175.0

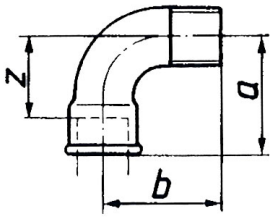

TFB 1A-12

Short bend 1a, 90°, female/male

Type No.	Art. No.	Thread female	Thread male	a mm	b mm	z mm
TFB 1A-14	112836	Rp 1/4	R 1/4	30.0	30.0	20.0
TFB 1A-38	112837	Rp 3/8	R 3/8	36.0	36.0	26.0
TFB 1A-12	112838	Rp 1/2	R 1/2	45.0	45.0	32.0
TFB 1A-34	112839	Rp 3/4	R 3/4	50.0	50.0	35.0
TFB 1A-10	112840	Rp 1	R 1	63.0	63.0	46.0
TFB 1A-114	112841	Rp 1 1/4	R 1 1/4	76.0	76.0	57.0
TFB 1A-112	112842	Rp 1 1/2	R 1 1/2	85.0	85.0	66.0
TFB 1A-20	112843	Rp 2	R 2	102.0	102.0	78.0
TFB 1A-212	112844	Rp 2 1/2	R 2 1/2	-	-	-

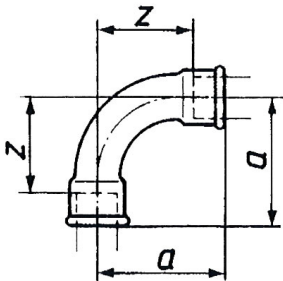

TFB 2-12

Long sweep bend 2, 90°, female/female

Type No.	Art. No.	Thread female	a mm	z mm
TFB 2-14	112845	Rp/Rp 1/4	40.0	30.0
TFB 2-38	112846	Rp/Rp 3/8	48.0	38.0
TFB 2-12	112847	Rp/Rp 1/2	55.0	42.0
TFB 2-34	112848	Rp/Rp 3/4	69.0	54.0
TFB 2-10	112849	Rp/Rp 1	85.0	68.0
TFB 2-114	112850	Rp/Rp 1 1/4	105.0	86.0
TFB 2-112	112851	Rp/Rp 1 1/2	116.0	97.0
TFB 2-20	112852	Rp/Rp 2	140.0	116.0
TFB 2-212	112853	Rp 2 1/2	176.0	149.0
TFB 2-30	112854	Rp 3	205.0	175.0

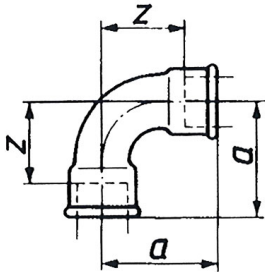

TFB 2A-10

Short bend 2a, 90°, female/female

Type No.	Art. No.	Thread female	a mm	z mm
TFB 2A-14	112855	Rp/Rp 1/4	30.0	20.0
TFB 2A-38	112856	Rp/Rp 3/8	36.0	26.0
TFB 2A-12	112857	Rp/Rp 1/2	45.0	32.0
TFB 2A-34	112858	Rp/Rp 3/4	50.0	35.0
TFB 2A-10	112859	Rp/Rp 1	63.0	46.0
TFB 2A-114	112860	Rp/Rp 1 1/4	76.0	57.0
TFB 2A-112	112861	Rp/Rp 1 1/2	85.0	66.0
TFB 2A-20	112862	Rp/Rp 2	102.0	78.0

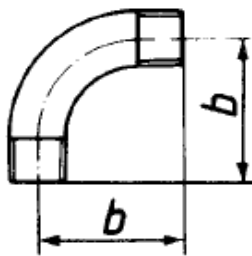

TFB 3-34

Long sweep bend 3, 90°, male/male

Type No.	Art. No.	Thread female	b mm
TFB 3-38	112863	R 3/8	42.0
TFB 3-12	112864	R 1/2	48.0
TFB 3-34	112865	R 3/4	60.0
TFB 3-10	112866	R 1	75.0
TFB 3-114	112867	R 1 1/4	95.0
TFB 3-112	112868	R 1 1/2	105.0
TFB 3-20	112869	R 2	130.0

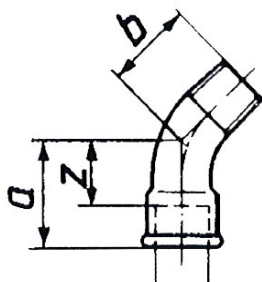

TFB 40-10

Bend 40, 45°, female/male

Type No.	Art. No.	Thread female	Thread male	a mm	b mm	z mm
TFB 40-14	112870	Rp 1/4	R 1/4	26.0	21.0	16.0
TFB 40-38	112871	Rp 3/8	R 3/8	30.0	24.0	20.0
TFB 40-12	112872	Rp 1/2	R 1/2	36.0	30.0	23.0
TFB 40-34	112873	Rp 3/4	R 3/4	43.0	36.0	28.0
TFB 40-10	112874	Rp 1	R 1	51.0	42.0	34.0
TFB 40-114	112875	Rp 1 1/4	R 1 1/4	64.0	54.0	45.0
TFB 40-112	112876	Rp 1 1/2	R 1 1/2	68.0	58.0	49.0
TFB 40-20	112877	Rp 2	R 2	81.0	70.0	57.0
TFB 40-212	112878	Rp 2 1/2	R 2 1/2	99.0	86.0	72.0
TFB 40-30	112879	Rp 3	R 3	113.0	100.0	83.0

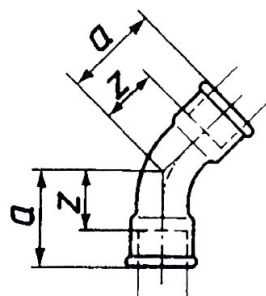

TFB 41-10

Bend 41, 45°, female/female

Type No.	Art. No.	Thread female	a mm	z mm
TFB 41-38	112880	Rp/Rp 3/8	30.0	20.0
TFB 41-12	112881	Rp/Rp 1/2	36.0	23.0
TFB 41-34	112882	Rp/Rp 3/4	43.0	28.0
TFB 41-10	112883	Rp/Rp 1	51.0	34.0
TFB 41-114	112884	Rp/Rp 1 1/4	64.0	45.0
TFB 41-112	112885	Rp/Rp 1 1/2	68.0	49.0
TFB 41-20	112886	Rp/Rp 2	81.0	57.0
TFB 41-212	112887	Rp/Rp 2 1/2	99.0	72.0
TFB 41-30	112888	Rp/Rp 3	113.0	83.0

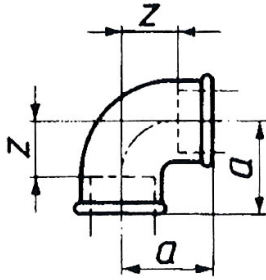

TFW 90-12

Elbow 90, 90°, female/female

Type. No.	Art. No.	Thread female	a mm	z mm
TFW 90-14	112889	Rp/Rp 1/4	21.0	11.0
TFW 90-38	112890	Rp/Rp 3/8	25.0	15.0
TFW 90-12	112891	Rp/Rp 1/2	28.0	15.0
TFW 90-34	112892	Rp/Rp 3/4	33.0	18.0
TFW 90-10	112893	Rp/Rp 1	38.0	21.0
TFW 90-114	112894	Rp/Rp 1 1/4	45.0	26.0
TFW 90-112	112895	Rp/Rp 1 1/2	50.0	31.0
TFW 90-20	112896	Rp/Rp 2	58.0	34.0
TFW 90-212	112897	Rp/Rp 2 1/2	69.0	42.0
TFW 90-30	112898	Rp/Rp 3	78.0	48.0

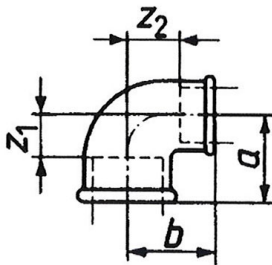

TFW 90-1012

Elbow 90, 90°, reduced, female/female

Type No.	Art. No.	Thread female	Thread female	a mm	b mm	c mm	z ₁ mm	z ₂ mm
TFW 90-1238	133560	Rp 1/2	Rp 3/8	26.0	26.0	33.0	13.0	16.0
TFW 90-3412	133561	Rp 3/4	Rp 1/2	30.0	31.0	40.0	15.0	18.0
TFW 90-1012	133562	Rp 1	Rp 1/2	32.0	34.0	-	15.0	21.0
TFW 90-1034	133563	Rp 1	Rp 3/4	35.0	36.0	46.0	18.0	21.0
TFW 90-11410	133564	Rp 1 1/4	Rp 1	40.0	42.0	56.0	21.0	25.0
TFW 90-11212	133565	Rp 1 1/2	Rp 1/2	-	-	-	-	-
TFW 90-112114	133566	Rp 1 1/2	Rp 1 1/4	46.0	48.0	-	27.0	29.0
TFW 90-21	133567	Rp 2	Rp 1	-	-	-	-	-
TFW 90-212112	133568	Rp 2 1/2	Rp 1 1/2	-	-	-	-	-

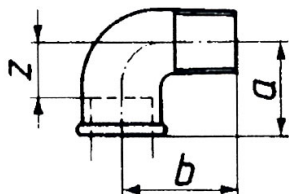

TFW 92-12

Elbow 92, 90°, female/male

Type No.	Art. No.	Thread female	Thread male	a mm	b mm	z mm
TFW 92-14	112899	Rp 1/4	R 1/4	21.0	28.0	11.0
TFW 92-38	112900	Rp 3/8	R 3/8	25.0	32.0	15.0
TFW 92-12	112901	Rp 1/2	R 1/2	28.0	37.0	15.0
TFW 92-34	112902	Rp 3/4	R 3/4	33.0	43.0	18.0
TFW 92-10	112903	Rp 1	R 1	38.0	52.0	21.0
TFW 92-114	112904	Rp 1 1/4	R 1 1/4	45.0	60.0	26.0
TFW 92-112	112905	Rp 1 1/2	R 1 1/2	50.0	65.0	31.0
TFW 92-20	112906	Rp 2	R 2	58.0	74.0	34.0
TFW 92-212	112907	Rp 2 1/2	R 2 1/2	69.0	88.0	42.0
TFW 92-30	112908	Rp 3	R 3	78.0	98.0	48.0

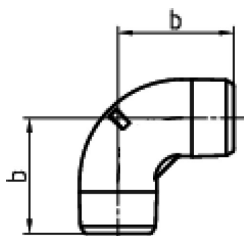

TFW 94-38

Elbow 94, 90°, male/male

Type No.	Art. No.	Thread male	b mm
TFW 94-38	112909	R/R 3/8	30.0
TFW 94-12	112910	R/R 1/2	37.0
TFW 94-34	112911	R/R 3/4	40.0
TFW 94-10	112912	R/R 1	47.0
TFW 94-114	112913	R/R 1 1/4	57.0
TFW 94-112	112914	R/R 1 1/2	60.0
TFW 94-20	112915	R/R 2	70.0

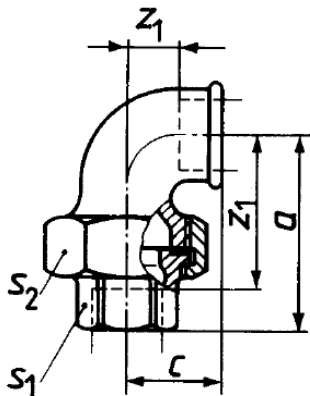

TFV 95-10

Union elbow 95, flat seat, female/female, without seal
 Temperature range -20 °C to 200 °C

Type No.	Art. No.	Thread female	a mm	b mm	c mm	z ₁ mm
TFV 95-12	112916	Rp 1/2	58.0	76.0	28.0	15.0
TFV 95-34	112917	Rp 3/4	62.0	82.0	33.0	18.0
TFV 95-10	112918	Rp 1	72.0	94.0	38.0	21.0
TFV 95-114	112919	Rp 1 1/4	82.0	107.0	45.0	26.0
TFV 95-112	112920	Rp 1 1/2	90.0	115.0	50.0	31.0
TFV 95-20	112921	Rp 2	100.0	128.0	58.0	34.0

→ Maximum temperature and maximum operating pressure should not occur at the same time!

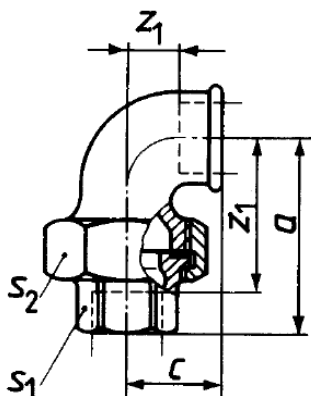

TFV 96-10

Union elbow 96, taper seat, female/female

Type No.	Art. No.	Thread female	a mm	b mm	Z1 mm
TFV 96-12	112922	Rp 1/2	58.0	76.0	15.0
TFV 96-34	112923	Rp 3/4	62.0	82.0	18.0
TFV 96-10	112924	Rp 1	72.0	94.0	21.0
TFV 96-114	112925	Rp 1 1/4	82.0	107.0	26.0
TFV 96-112	112926	Rp 1 1/2	90.0	115.0	31.0
TFV 96-20	112927	Rp 2	100.0	128.0	34.0
TFV 96-212	112928	Rp 2 1/2	-	-	-

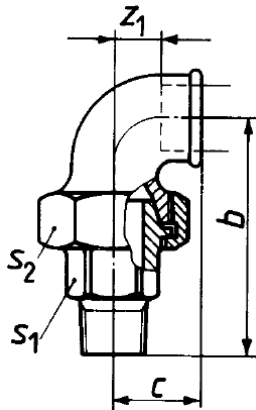

TFV 98-10

Union elbow 97, flat seat, female/male, without seal
 Temperature range -20 °C to 200 °C

Type No.	Art. No.	Thread 1 male	Thread 2 male	b mm	c mm	z ₁ mm
TFV 97-12	112929	Rp 1/2	R 1/2	76.0	28.0	15.0
TFV 97-34	112930	Rp 3/4	R 3/4	82.0	33.0	18.0
TFV 97-10	112931	Rp 1	R 1	94.0	38.0	21.0
TFV 97-114	112932	Rp 1 1/4	R 1 1/4	45.0	45.0	26.06
TFV 97-112	112933	Rp 1 1/2	R 1 1/2	115.0	50.0	31.0
TFV 97-20	112934	Rp 2	R 2	128.0	58.0	34.0

→ Maximum temperature and maximum operating pressure should not occur at the same time!

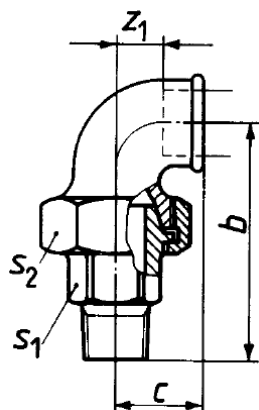

TFV 98-10

Union elbow 98, taper seat, female/male

Type No.	Art. No.	Thread 1 male	Thread 2 male	b mm	c mm	z1 mm
TFV 98-14	112935	Rp 1/4	R 1/4	61.0	21.0	11.0
TFV 98-12	112936	Rp 1/2	R 1/2	76.0	28.0	15.0
TFV 98-34	112937	Rp 3/4	R 3/4	82.0	33.0	18.0
TFV 98-10	112938	Rp 1	R 1	94.0	38.0	21.0
TFV 98-114	112939	Rp 1 1/4	R 1 1/4	107.0	45.0	26.0
TFV 98-112	112940	Rp 1 1/2	R 1 1/2	115.0	50.0	31.0
TFV 98-20	112941	Rp 2	R 2	128.0	58.0	34.0
TFV 98-212	112942	Rp 2 1/2	R 2 1/2	-	-	-

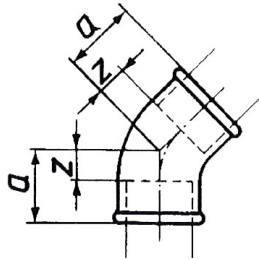

TFW 120-12

Elbow 120, 45°, female/female

Type No.	Art. No.	Thread female	a mm	z mm
TFW 120-38	112943	Rp/Rp 3/8	20.0	10.0
TFW 120-12	112944	Rp/Rp 1/2	22.0	9.0
TFW 120-34	112945	Rp/Rp 3/4	25.0	10.0
TFW 120-10	112946	Rp/Rp 1	28.0	11.0
TFW 120-114	112947	Rp/Rp 1 1/4	33.0	14.0
TFW 120-112	112948	Rp/Rp 1 1/2	36.0	17.0
TFW 120-20	112949	Rp/Rp 2	43.0	19.0
TFW 120-212	112950	Rp 2 1/2	-	-
TFW 120-30	112951	Rp 3	-	-

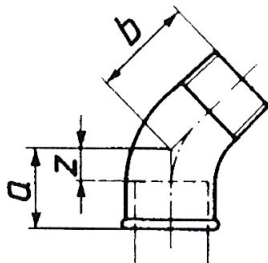

TFW 121-12

Elbow 121, 45°, female/male

Type No.	Art. No.	Thread female	Thread male	a mm	b mm	z mm
TFW 121-38	112952	Rp 3/8	R 3/8	20.0	25.0	10.0
TFW 121-12	112953	Rp 1/2	R 1/2	22.0	28.0	9.0
TFW 121-34	112954	Rp 3/4	R 3/4	25.0	32.0	10.0
TFW 121-10	112955	Rp 1	R 1	28.0	37.0	11.0
TFW 121-114	112956	Rp 1 1/4	R 1 1/4	33.0	43.0	14.0
TFW 121-112	112957	Rp 1 1/2	R 1 1/2	36.0	46.0	17.0
TFW 121-20	112958	Rp 2	R 2	43.0	55.0	19.0

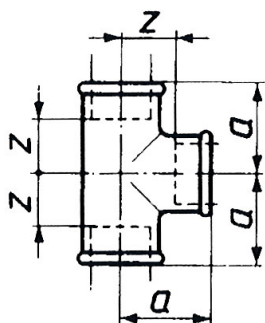

TFT 130-12

Tee 130, female/female/female

Type No.	Art. No.	Thread female	a mm	z mm
TFT 130-14	112959	Rp 1/4	21.0	11.0
TFT 130-38	112960	Rp 3/8	25.0	15.0
TFT 130-12	112961	Rp 1/2	28.0	15.0
TFT 130-34	112962	Rp 3/4	33.0	18.0
TFT 130-10	112963	Rp 1	38.0	21.0
TFT 130-114	112964	Rp 1 1/4	45.0	26.0
TFT 130-112	112965	Rp 1 1/2	50.0	31.0
TFT 130-20	112966	Rp 2	58.0	34.0
TFT 130-212	112967	Rp 2 1/2	69.0	42.0
TFT 130-30	112968	Rp 3	78.0	48.0

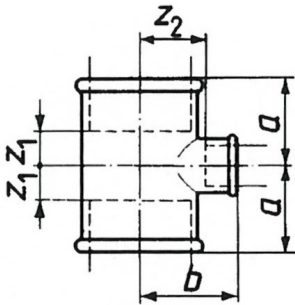

TFT 130-3438

Tee 130, reducing, female/female/female

Type No.	Art. No.	Thread 1	Thread 2 Reduced branch tee	a mm	b mm	z ₁ mm	z ₂ mm
TFT 130-3814	112969	Rp/Rp 3/8	Rp1/4	23.0	23.0	13.0	13.0
TFT 130-1214	112970	Rp/Rp 1/2	Rp 1/4	24.0	24.0	11.0	14.0
TFT 130-1238	112971	Rp/Rp 1/2	Rp 3/8	26.0	26.0	13.0	16.0
TFT 130-3414	125298	Rp/Rp 3/4	Rp 1/4	26.0	27.0	11.0	17.0
TFT 130-3438	112973	Rp/Rp 3/4	Rp 3/8	28.0	28.0	13.0	18.0
TFT 130-3412	112974	Rp/Rp 3/4	Rp 1/2	30.0	31.0	15.0	18.0
TFT 130-1038	112975	Rp/Rp 1	Rp 3/8	30.0	32.0	13.0	22.0
TFT 130-1012	112976	Rp/Rp 1	Rp 1/2	32.0	34.0	15.0	21.0
TFT 130-1034	112977	Rp/Rp 1	Rp 3/4	35.0	36.0	18.0	21.0
TFT 130-11438	125297	Rp/Rp 1 1/4	Rp 3/8	32.0	36.0	13.0	26.0
TFT 130-11412	112979	Rp/Rp 1 1/4	Rp 1/2	34.0	38.0	15.0	25.0
TFT 130-11434	112980	Rp/Rp 1 1/4	Rp 3/4	36.0	41.0	17.0	26.0
TFT 130-11410	112981	Rp/Rp 1 1/4	Rp 1	40.0	42.0	21.0	25.0
TFT 130-11238	125296	Rp/Rp 1 1/2	Rp 3/8	33.0	38.0	14.0	28.0
TFT 130-11212	112983	Rp/Rp 1 1/2	Rp 1/2	36.0	42.0	17.0	29.0
TFT 130-11234	112984	Rp/Rp 1 1/2	Rp 3/4	38.0	44.0	19.0	29.0
TFT 130-11210	112985	Rp/Rp 1 1/2	Rp 1	42.0	46.0	23.0	29.0
TFT130-112114	112986	Rp/Rp 1 1/2	Rp 1 1/4	46.0	48.0	27.0	29.0
TFT 130-2012	112987	Rp/Rp 2	Rp 1/2	38.0	48.0	14.0	35.0
TFT 130-2034	112988	Rp/Rp 2	Rp 3/4	40.0	50.0	16.0	35.0
TFT 130-2010	112989	Rp/Rp 2	Rp 1	44.0	52.0	20.0	35.0
TFT 130-20114	112990	Rp/Rp 2	Rp 1 1/4	48.0	54.0	24.0	35.0
TFT 130-20112	112991	Rp/Rp 2	Rp 1 1/2	52.0	55.0	28.0	36.0
TFT 130-21210	112992	Rp/Rp 2 1/2	Rp 1	47.0	60.0	20.0	43.0
TFT130-212114	112993	Rp/Rp 2 1/2	Rp 1 1/4	52.0	62.0	25.0	43.0
TFT130-212112	112994	Rp/Rp 2 1/2	Rp 1 1/2	55.0	63.0	28.0	44.0
TFT 130-21220	112995	Rp/Rp 2 1/2	Rp 2	61.0	66.0	34.0	42.0
TFT 130-3020	112996	Rp/Rp 3	Rp 2	64.0	73.0	34.0	49.0
TFT 130-30212	112997	Rp/Rp 3	Rp 1 1/2	58.0	71.0	28.0	52.0

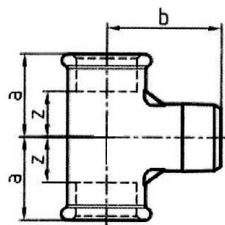

TFT 133-38

Tee 133, female/male/female

Type No.	Art. No.	Thread	a mm	b mm	z mm
TFT 133-38	112998	Rp 3/8	22.0	31.0	12.0
TFT 133-12	112999	Rp 1/2	25.0	38.0	12.0
TFT 133-10	113000	Rp 1	39.0	53.0	22.0



TFT 134-10

Tee 134, female/female/male

Type No.	Art. No.	Thread 1	Thread 2	Thread 3
TFT 134-12	113001	Rp 1/2	R 1/2	Rp 1/2
TFT 134-34	113002	Rp 3/4	R 3/4	Rp 3/4
TFT 134-10	113003	Rp 1	R 1	Rp 1
TFT 134-114	113004	Rp 1 1/4	R 1 1/4	Rp 1 1/4
TFT 134-112	113005	Rp 1 1/2	R 1 1/2	Rp 1 1/2
TFT 134-20	113006	Rp 2	R 2	Rp 2

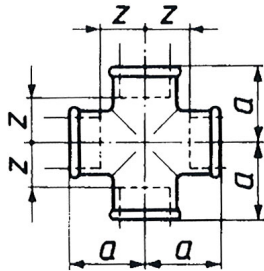

TFK 180-12

Cross 180, 4 x female

Type No.	Art. No.	Thread female	a mm	z mm
TFK 180-14	113007	Rp 1/4	21.0	11.0
TFK 180-38	113008	Rp 3/8	25.0	15.0
TFK 180-12	113009	Rp 1/2	28.0	15.0
TFK 180-34	113010	Rp 3/4	33.0	18.0
TFK 180-10	113011	Rp 1	38.0	21.0
TFK 180-114	113012	Rp 1 1/4	45.0	26.0
TFK 180-112	113013	Rp 1 1/2	50.0	31.0
TFK 180-20	113014	Rp 2	58.0	34.0
TFK 180-30	113015	Rp 3	78.0	48.0

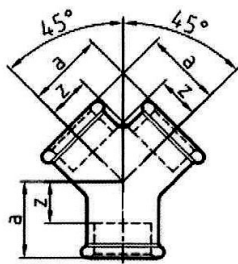

TFY 22-10

Y-piece 220, female/female/female

Type No.	Art. No.	Thread female	a mm	z mm
TFY 220-12	113016	Rp 1/2	27.0	14.0
TFY 220-34	113017	Rp 3/4	33.0	18.0
TFY 220-10	113018	Rp 1	40.0	23.0

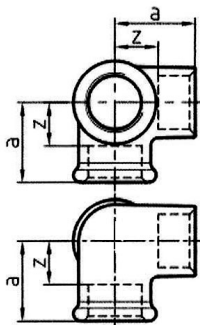

TFE 221-10

Elbow connector 221, female/female/female

Type No.	Art. No.	Thread female	a mm	z mm
TFE 221-12	113019	Rp 1/2	28.0	15.0
TFE 221-34	113020	Rp 3/4	33.0	18.0
TFE 221-10	113021	Rp 1	38.0	21.0
TFE 221-112	113022	Rp 1 1/2	50.0	31.0
TFE 221-20	113023	Rp 2	58.0	34.0

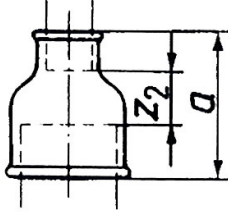

TFM 240-1012

Socket 240, reducing, female/female

Type No.	Art. No.	Thread 1 female	Thread 2 female	a mm	Z ₂ mm
TFM 240-3814	113024	Rp 3/8	Rp 1/4	30.0	10.0
TFM 240-1214	113025	Rp 1/2	Rp 1/4	36.0	13.0
TFM 240-1238	113026	Rp 1/2	Rp 3/8	36.0	13.0
TFM 240-3414	113027	Rp 3/4	Rp 1/4	39.0	14.0
TFM 240-3438	113028	Rp 3/4	Rp 3/8	39.0	14.0
TFM 240-3412	113029	Rp 3/4	Rp 1/2	38.0	11.0
TFM 240-1038	113030	Rp 1	Rp 3/8	45.0	18.0
TFM 240-1012	113031	Rp 1	Rp 1/2	45.0	15.0
TFM 240-1034	113032	Rp 1	Rp 3/4	45.0	13.0
TFM 240-11438	125295	Rp 1 1/4	Rp 3/8	50.0	21.0
TFM 240-11412	113034	Rp 1 1/4	Rp 1/2	50.0	18.0
TFM 240-11434	113035	Rp 1 1/4	Rp 3/4	50.0	16.0
TFM 240-11410	113036	Rp 1 1/4	Rp 1	50.0	14.0
TFM 240-11212	113037	Rp 1 1/2	Rp 1/2	55.0	23.0
TFM 240-11234	113038	Rp 1 1/2	Rp 3/4	55.0	21.0
TFM 240-11210	113039	Rp 1 1/2	Rp 1	55.0	19.0
TFM240-112114	113040	Rp 1 1/2	Rp 1 1/4	55.0	17.0
TFM 240-2012	113041	Rp 2	Rp 1/2	65.0	28.0
TFM 240-2034	113042	Rp 2	Rp 3/4	65.0	26.0
TFM 240-2010	113043	Rp 2	Rp 1	65.0	24.0
TFM 240-20114	113044	Rp 2	Rp 1 1/4	65.0	22.0
TFM 240-20112	113045	Rp 2	Rp 1 1/2	65.0	22.0
TFM 240-21220	113046	Rp 2 1/2	Rp 2	74.0	23.0
TFM 240-30112	113047	Rp 3	Rp 1 1/2	80.0	31.0
TFM 240-3020	113048	Rp 3	Rp 2	80.0	26.0
TFM 240-30212	113049	Rp 3	Rp 2 1/2	80.0	23.0

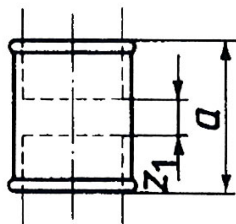

TFM 270-12

Socket 270, female/female

Type No.	Art. No.	Thread female	a mm	z ₁ mm
TFM 270-14	113050	Rp/Rp 1/4	27.0	7.0
TFM 270-38	113051	Rp/Rp 3/8	30.0	10.0
TFM 270-12	113052	Rp/Rp 1/2	36.0	10.0
TFM 270-34	113053	Rp/Rp 3/4	39.0	9.0
TFM 270-10	113054	Rp/Rp 1	45.0	11.0
TFM 270-114	113055	Rp/Rp 1 1/4	50.0	12.0
TFM 270-112	113056	Rp/Rp 1 1/2	50.0	17.0
TFM 270-20	113057	Rp/Rp 2	65.0	17.0
TFM 270-212	113058	Rp 2 1/2	74.0	20.0
TFM 270-30	113059	Rp 3	80.0	20.0

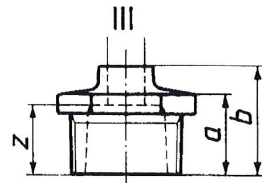
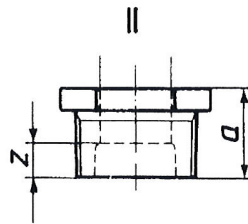
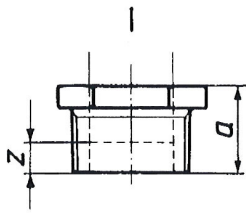

TFR 241-1214

Reducing bush 241, male/female

Type No.	Art. No.	Thread 1 male	Thread 2 female	a mm	b mm	z mm	Type
TFR 241-3814	113060	R 3/8	Rp 1/4	20.0	-	10.0	I
TFR 241-1214	113061	R 1/2	Rp 1/4	24.0	-	14.0	II
TFR 241-1238	113062	R 1/2	Rp 3/8	24.0	-	14.0	I
TFR 241-3414	113063	R 3/4	Rp 1/4	26.0	-	16.0	II
TFR 241-3438	113064	R 3/4	Rp 3/8	26.0	-	16.0	II
TFR 241-3412	113065	R 3/4	Rp 1/2	26.0	-	13.0	I
TFR 241-1038	113066	R 1	Rp 3/8	29.0	-	19.0	II
TFR 241-1012	113067	R 1	Rp 1/2	29.0	-	16.0	II
TFR 241-1034	113068	R 1	Rp 3/4	29.0	-	14.0	I
TFR 241-11438	113069	R 1 1/4	Rp 3/8	31.0	-	21.0	II
TFR 241-11412	113070	R 1 1/4	Rp 1/2	31.0	-	18.0	II
TFR 241-11434	113071	R 1 1/4	Rp 3/4	31.0	-	16.0	II
TFR 241-11410	113072	R 1 1/4	Rp 1	31.0	-	14.0	I
TFR 241-11238	113073	R 1 1/2	Rp 3/8	31.0	-	21.0	II
TFR 241-11212	113074	R 1 1/2	Rp 1/2	31.0	-	18.0	II
TFR 241-11234	113075	R 1 1/2	Rp 3/4	31.0	-	16.0	II
TFR 241-11210	113076	R 1 1/2	Rp 1	31.0	-	14.0	II
TFR241-112114	113077	R 1 1/2	Rp 1 1/4	31.0	-	12.0	I
TFR 241-2012	113078	R 2	Rp 1/2	35.0	48.0	35.0	III
TFR 241-2034	113079	R 2	Rp 3/4	35.0	48.0	33.0	III
TFR 241-2010	113080	R 2	Rp 1	35.0	-	18.0	II
TFR 241-20114	113081	R 2	Rp 1 1/4	35.0	-	16.0	II
TFR 241-20112	113082	R 2	Rp 1 1/2	35.0	-	16.0	II
TFR241-212112	113083	R 2 1/2	Rp 1 1/2	40.0	-	21.0	II
TFR 241-21220	113084	R 2 1/2	Rp 2	40.0	-	16.0	II
TFR 241-30112	113085	R 3	Rp 1 1/2	44.0	59.0	40.0	III
TFR 241-3020	113086	R 3	Rp 2	44.0	-	20.0	II
TFR 241-30212	113087	R 3	Rp 2 1/2	44.0	-	17.0	II

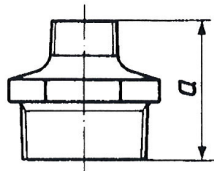

TFD 245-1238

Hexagon nipple 245, reducing, male/male

Type No.	Art. No.	Thread 1 male	Thread 2 male	a mm
TFD 245-3814	113088	R 3/8	R 1/4	38.0
TFD 245-1214	113089	R 1/2	R 1/4	44.0
TFD 245-1238	113090	R 1/2	R 3/8	44.0
TFD 245-3438	113091	R 3/4	R 3/8	47.0
TFD 245-3412	113092	R 3/4	R 1/2	47.0
TFD 245-1012	113093	R 1	R 1/2	53.0
TFD 245-1034	113094	R 1	R 3/4	53.0
TFD 245-11434	113095	R 1 1/4	R 3/4	57.0
TFD 245-11410	113096	R 1 1/4	R 1	57.0
TFD 245-11212	133569	R 1 1/2	R 1/2	-
TFD 245-11234	133570	R 1 1/2	R 3/4	59.0
TFD 245-11210	113097	R 1 1/2	R 1	59.0
TFD245-112114	113098	R 1 1/2	R 1 1/4	59.0
TFD 245-234	133571	R 2	R 3/4	-
TFD 245-20114	113099	R 2	R 1 1/4	68.0
TFD 245-20112	113100	R 2	R 1 1/2	68.0
TFD245-212112	113101	R 2 1/2	R 1 1/2	75.0
TFD 245-21220	113102	R 2 1/2	R 2	75.0
TFD 245-3020	113103	R 3	R 2	83.0
TFD 245-30212	113104	R 3	R 2 1/2	83.0

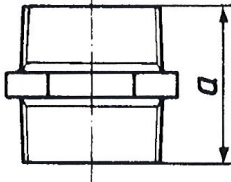

TFD 280-12

Hexagon nipple 280, male/male

Type No.	Art. No.	Thread male	a mm
TFD 280-14	113105	R 1/4	36.0
TFD 280-38	113106	R 3/8	38.0
TFD 280-12	113107	R 1/2	44.0
TFD 280-34	113108	R 3/4	47.0
TFD 280-10	113109	R 1	53.0
TFD 280-114	113110	R 1 1/4	57.0
TFD 280-112	113111	R 1 1/2	59.0
TFD 280-20	113112	R 2	68.0
TFD 280-212	113113	R 2 1/2	-
TFD 280-30	113114	R 3	-

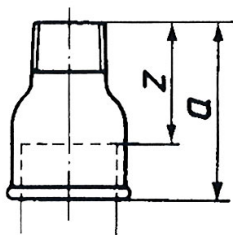

TFM 246-1012

Socket 246, reducing, female/male

Type No.	Art. No.	Thread 1 female	Thread 2 male	a mm	z mm
TFM 246-3814	113115	Rp 3/8	R 1/4	35.0	25.0
TFM 246-1214	113116	Rp 1/2	R 1/4	43.0	30.0
TFM 246-1238	113117	Rp 1/2	R 3/8	43.0	30.0
TFM 246-3412	113118	Rp 3/4	R 1/2	48.0	33.0
TFM 246-1012	113119	Rp 1	R 1/2	55.0	38.0
TFM 246-1034	113120	Rp 1	R 3/4	55.0	38.0
TFM 246-11434	113121	Rp 1 1/4	R 3/4	60.0	41.0
TFM 246-11410	113122	Rp 1 1/4	R 1	60.0	41.0
TFM 246-11210	113123	Rp 1 1/2	R 1	63.0	44.0
TFM246-112114	113124	Rp 1 1/2	R 1 1/4	63.0	44.0
TFM 246-2010	113125	Rp 2	R 1	65.0	43.0
TFM 246-20114	113126	Rp 2	R 1 1/4	70.0	46.0
TFM 246-20112	113127	Rp 2	R 1 1/2	70.0	46.0
TFM 246-21220	113128	Rp 2 1/2	R 2	-	-
TFM 246-3020	113129	Rp 3	R 2	-	-
TFM 246-30212	113130	Rp 3	R 2 1/2	-	-

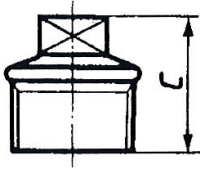

TFS 290-10

Plugs 290, male

Type No.	Art. No.	Thread male	Min. c mm
TFS 290-14	113131	R 1/4	22.0
TFS 290-38	113132	R 3/8	24.0
TFS 290-12	113133	R 1/2	26.0
TFS 290-34	113134	R 3/4	32.0
TFS 290-10	113135	R 1	36.0
TFS 290-114	113136	R 1 1/4	39.0
TFS 290-112	113137	R 1 1/2	41.0
TFS 290-20	113138	R 2	48.0
TFS 290-212	113139	R 2 1/2	54.0
TFS 290-30	113140	R 3	60.0



TFK 300-12

Cap 300, female

Type No.	Art. No.	Thread female	Min. a mm
TFK 300-14	113141	Rp 1/4	15.0
TFK 300-38	113142	Rp 3/8	17.0
TFK 300-12	113143	Rp 1/2	19.0
TFK 300-34	113144	Rp 3/4	22.0
TFK 300-10	113145	Rp 1	24.0
TFK 300-114	113146	Rp 1 1/4	27.0
TFK 300-112	113147	Rp 1 1/2	27.0
TFK 300-20	113148	Rp 2	32.0
TFK 300-212	113149	Rp 2 1/2	35.0
TFK 300-30	113150	Rp 3	38.0

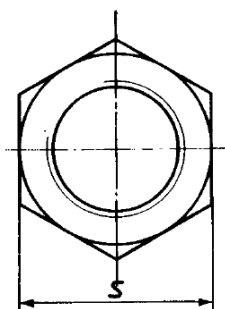

TFG 310-10

Lock nut 310, female

Type No.	Art. No.	Thread male	Min. a mm
TFG 310-14	113151	Rp 1/4	6.0
TFG 310-38	113152	Rp 3/8	7.0
TFG 310-12	113153	Rp 1/2	8.0
TFG 310-34	113154	Rp 3/4	9.0
TFG 310-10	113155	Rp 1	10.0
TFG 310-112	113156	Rp 1 1/2	12.0
TFG 310-20	113157	Rp 2	13.0
TFG 310-212	113158	Rp 2 1/2	16.0
TFG 310-30	113159	Rp 3	19.0

*The measure of a/f (s) depends on the construction of the fittings and is up to the manufacturer.

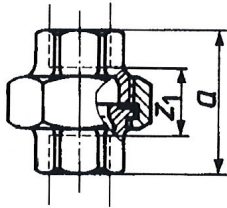

TFV 330-12

Union 330, flat seat, female/female, with NBR-seal (NBR with aramide fiber)

Temperature -20 °C to 200 °C

Type No.	Art. No.	Thread female	a mm	z ₁ mm
TFV 330-14-D	113160	Rp/Rp 1/4	42.0	22.0
TFV 330-38-D	113161	Rp/Rp 3/8	45.0	25.0
TFV 330-12-D	113162	Rp/Rp 1/2	48.0	22.0
TFV 330-34-D	113163	Rp/Rp 3/4	52.0	22.0
TFV 330-10-D	113164	Rp/Rp 1	58.0	24.0
TFV 330-114-D	113165	Rp/Rp 1 1/4	65.0	27.0
TFV 330-112-D	113166	Rp/Rp 1 1/2	70.0	32.0
TFV 330-20-D	113167	Rp/Rp 2	78.0	30.0
TFV 330-212-D	113168	Rp/Rp 2 1/2	85.0	31.0
TFV 330-30-D	113169	Rp/Rp 3	95.0	35.0

→ Maximum temperature and maximum operating pressure should not occur at the same time!

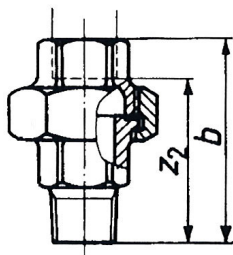

TFV 331-12

Union 331, flat seat, female/male, with NBR-seal (NBR with aramide fiber)
 Temperature -20 °C to 200 °C

Type No.	Art. No.	Thread female	Thread male	b mm	z ₂ mm
TFV 331-14-D	113170	Rp 1/4	R 1/4	55.0	45.0
TFV 331-38-D	113171	Rp 3/8	R 3/8	58.0	48.0
TFV 331-12-D	113172	Rp 1/2	R 1/2	66.0	53.0
TFV 331-34-D	113173	Rp 3/4	R 3/4	72.0	57.0
TFV 331-10-D	113174	Rp 1	R 1	80.0	63.0
TFV 331-114-D	113175	Rp 1 1/4	R 1 1/4	90.0	71.0
TFV 331-112-D	113176	Rp 1 1/2	R 1 1/2	95.0	76.0
TFV 331-20-D	113177	Rp 2	R 2	106.0	82.0
TFV 331-212-D	113178	Rp 2 1/2	R 2 1/2	118.0	91.0

→ Maximum temperature and maximum operating pressure should not occur at the same time!

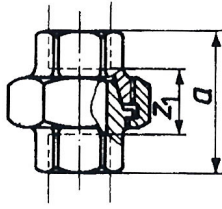

TFV 340-12

Union 340, taper seat, female/female

Type No.	Art. No.	Thread female	a mm	Z1 mm
TFV 340-14	113179	Rp/Rp 1/4	42.0	22.0
TFV 340-38	113180	Rp/Rp 3/8	45.0	25.0
TFV 340-12	113181	Rp/Rp 1/2	48.0	22.0
TFV 340-34	113182	Rp/Rp 3/4	52.0	22.0
TFV 340-10	113183	Rp/Rp 1	58.0	24.0
TFV 340-114	113184	Rp/Rp 1 1/4	65.0	27.0
TFV 340-112	113185	Rp/Rp 1 1/2	70.0	32.0
TFV 340-20	113186	Rp/Rp 2	78.0	30.0
TFV 340-212	113187	Rp/Rp 2 1/2	85.0	31.0
TFV 340-30	113188	Rp/Rp 3	95.0	35.0

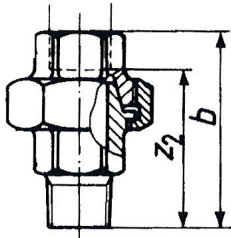

TFV 341-10

Union 341, taper seat, female/male

Type No.	Art. No.	Thread female	Thread male	b mm	Z2 mm
TFV 341-14	113189	Rp 1/4	R 1/4	55.0	45.0
TFV 341-38	113190	Rp 3/8	R 3/8	58.0	48.0
TFV 341-12	113191	Rp 1/2	R 1/2	66.0	53.0
TFV 341-34	113192	Rp 3/4	R 3/4	72.0	57.0
TFV 341-10	113193	Rp 1	R 1	80.0	63.0
TFV 341-114	113194	Rp 1 1/4	R 1 1/4	90.0	71.0
TFV 341-112	113195	Rp 1 1/2	R 1 1/2	95.0	76.0
TFV 341-20	113196	Rp 2	R 2	106.0	82.0
TFV 341-212	113197	Rp 2 1/2	Rp 2 1/2	118.0	91.0
TFV 341-30	113198	Rp 3	Rp 3	130.0	100.0

Flat seal for malleable iron fittings (NBR with aramide fiber)

Temperature -20 °C to 200 °C

Type No.	Art. No.	For connection size (inch)	O.D. mm	I.D. mm	Thickness mm
TFD 14-1	162262	1/4	24.0	17.0	2.0
TFD 38	113200	3/8	27.0	19.0	2.0
TFD 12	113201	1/2	30.0	21.0	2.0
TFD 34	113202	3/4	38.0	27.0	2.0
TFD 10	113203	1	44.0	32.0	2.0
TFD 114	113204	1 1/4	55.0	42.0	2.0
TFD 112	113205	1 1/2	62.0	46.0	2.0
TFD 20	113206	2	78.0	60.0	2.0
TFD 212	113207	2 1/2	97.0	75.0	2.0
TFD 30	113208	3	110.0	88.0	2.0



TFD 12

→ Maximum temperature and maximum operating pressure should not occur at the same time!

The specified dimensions are approximate dimensions in mm.

According to DIN EN 10242 the measure of a/f depends on the construction of the fittings and is up to the manufacturer.