

Purely pneumatic vacuum generator that operates on the Venturi principle. Compressed air enters the ejector at A and flows through the nozzle B. This results in a vacuum immediately behind the nozzle outlet, and air is drawn in through the vacuum inlet D. This air and the driving air leave the ejector via the silencer C.

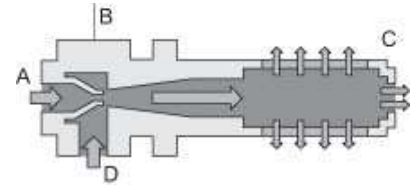

SBPC 20



SBPC 200

Characteristics:

- Vacuum generator with a single nozzle, available in six power ratings, with a high maximum vacuum value (85%)
- Connection of compressed air and vacuum with push-in coupling
- Basic housing with connection facility for a vacuum switch
- Maximum suction capacity with minimum compressed air consumption
- Minimum size, low weight
- Various power ratings for optimised air consumption

Applications:

- For universal use in handling systems with very high dynamic movements
- Handling all kinds of air-tight components
- For use in separation systems where space is restricted
- Construction of ejector blocks for centralised or decentralised individual control of suction pads

Body:	Plastic (impact-resistant)
Nozzle system:	Brass
Silencer:	Plastic
Connection:	Push-in coupling
Idle position of suction valve:	NO

Body

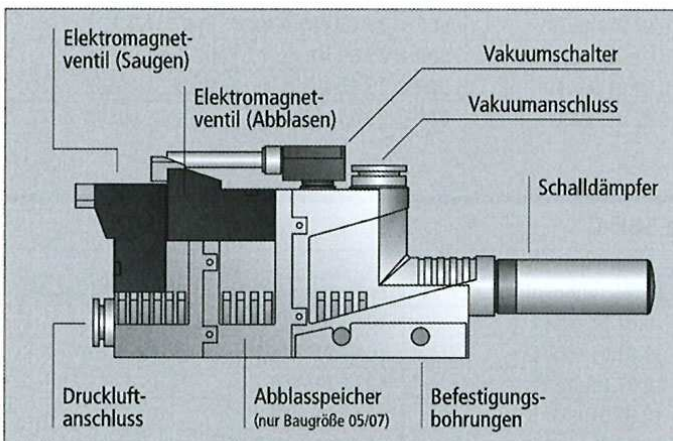

Systemaufbau Grundejektor SBP-C

Department eDocumentation

Phone. +49 7125 9497-41, -42, -53, -260, -330
Fax. +49 7125 9497-99
e-mail: eDocumentation@riegler.de

edition 11/2009 Subject technical changes.

RIEGLER & Co. KG
www.riegler.net

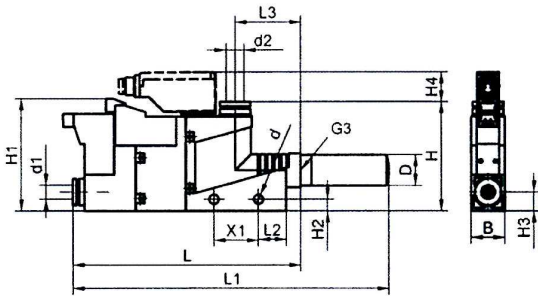

SBPC 10, SBPC 15, SBPC 100, SBPC 150

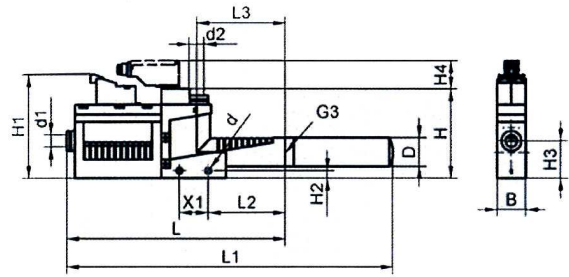

SBPC 20, SBPC 25, SBPC 200, SBPC 250

Basic ejectors »SBP-C« with blow-off valve, with integrated silencer

Art. No.	Nozzle- Ø	D	d	d1	d2	G3	H	H1	H2	H3	H4	L	L1	L2	L3	X1
SBPC 10	1.0	13.5	4.2	6.0	8.0	G 1/8" female	49.0	50.0	5.2	8.5	-	101.5	141.5	19.0	29.5	20.0
SBPC 15	1.5	13.5	4.2	6.0	8.0	G 1/8" female	49.0	50.0	5.2	8.5	-	101.5	141.5	19.0	29.5	20.0
SBPC 20	2.0	20.0	4.2	8.0	10.0	G 3/8" female	57.5	72.0	5.2	26.0	-	152.0	228.0	54.0	62.0	20.0
SBPC 25	2.5	20.0	4.2	8.0	10.0	G 3/8" female	57.5	72.0	5.2	26.0	-	152.0	228.0	54.0	62.0	20.0

Basic ejector »SBP-C« with blow-off valve and electronic vacuum switch, with integrated silencer

Art. No.	Nozzle- Ø	D	d	d1	d2	G3	H	H1	H2	H3	H4	L	L1	L2	L3	X1
SBPC 100	1.0	13.5	4.2	6.0	8.0	G 1/8" female	49.0	50.0	5.2	8.5	4.0	101.5	141.5	19.0	29.5	20.0
SBPC 150	1.5	13.5	4.2	6.0	8.0	G 1/8" female	49.0	50.0	5.2	8.5	4.0	101.5	141.5	19.0	29.5	20.0
SBPC 200	2.0	20.0	4.2	8.0	10.0	G 3/8" female	57.5	72.0	5.2	26.0	9.5	152.0	228.0	54.0	62.0	20.0
SBPC 250	2.5	20.0	4.2	8.0	10.0	G 3/8" female	57.5	72.0	5.2	26.0	9.5	152.0	228.0	54.0	62.0	20.0

All dimensions in mm.

Technical data

Art. No.	Evacuation degree [%]	Max. pumping speed [l/min]	Max. pumping speed [m ³ /h]	Air consumption suck [l/min]	Air consumption suck [m ³ /h]	Sound level sucked [db(A)]
SBPC 10 SBPC 100	85.0	38.0	2.3	48.0	2.9	59.0
SBPC 15 SBPC 150	85.0	70.0	4.2	118.0	7.1	65.0
SBPC 20 SBPC 200	85.0	123.0	7.4	208.0	12.5	68.0
SBPC 25 SBPC 250	85.0	215.0	12.9	311.0	18.7	70.0

Art. No.	Sound level free [db(A)]	Operating pressure [bar]	Recommended tube inside Ø air [mm]**	Recommended tube inside Ø vacuum [mm]**	Weight [g]	Operating temperature [°C]
SBPC 10 SBPC 100	65.0	3.0 - 6.0	4.0	6.0	105.0	0 – 50.0
SBPC 15 SBPC 150	72.0	3.0 - 6.0	4.0	6.0	105.0	0 – 50.0
SBPC 20 SBPC 200	77.0	3.0 - 6.0	6.0	7.0	143.0	0 – 50.0
SBPC 25 SBPC 250	78.0	3.0 - 6.0	6.0	7.0	143.0	0 – 50.0

The supply voltage in vacuum switches and electrical solenoid valves is 24V DC

** With max. 2 m length

Performance data

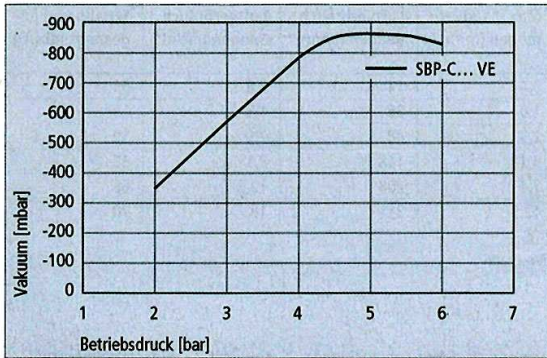

Erreichbares Vakuum bei unterschiedlichem Betriebsdruck

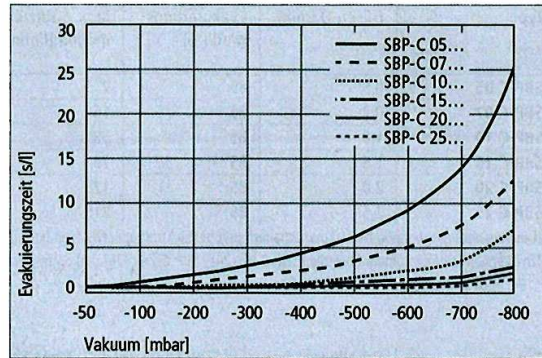

Evakuierungszeit bei verschiedenen Evakuierungsgraden

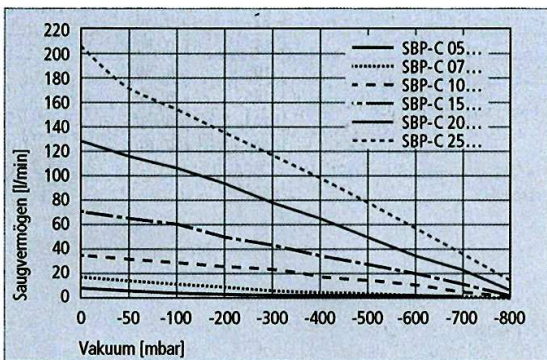

Saugvermögen bei verschiedenen Evakuierungsgraden

Pumping speed at different levels of evacuation in l / min

Art. No.	Evacuation degree in mbar									
	0	-50	-100	-200	-300	-400	-500	-600	-700	-800
SBPC 10 SBPC 100	38.0	33.2	30.1	26.7	23.0	18.6	14.9	9.8	5.2	1.6
SBPC 15 SBPC 150	70.0	65.0	60.1	52.0	44.0	36.5	29.0	20.5	11.4	2.2
SBPC 20 SBPC 200	123.0	115.0	104.0	93.0	78.0	64.0	49.0	35.5	23.0	8.0
SBPC 25 SBPC 250	215.0	175.0	157.5	139.5	119.0	99.5	79.6	59.0	37.3	16.3

Evacuation time for different vacuum ranges in s/l

Art. No.	Evacuation degree in mbar									
	-50	-100	-200	-300	-400	-500	-600	-700	-800	
SBPC 10 SBPC 100	0.06	0.14	0.30	0.52	0.82	1.30	1.98	3.26	6.56	
SBPC 15 SBPC 150	0.05	0.08	0.16	0.26	0.40	0.60	0.86	1.30	2.54	
SBPC 20 SBPC 200	0.03	0.05	0.09	0.16	0.24	0.34	0.49	0.80	1.74	
SBPC 25 SBPC 250	0.02	0.03	0.06	0.09	0.14	0.20	0.28	0.42	0.99	