

Stainless steel, 3-piece - length acc. to DIN 3202-M3.

Housing	Stainless steel 1.4408
Ball	Stainless steel 1.4401
Ball seal	PTFE (15 % glass fibre reinforced)
Stem seal	PTFE
Hand lever	Stainless steel 1.4301, with plastic coating
Operating temperature	-20 °C to 180 °C
Standard thread	G thread acc. to DIN EN ISO 228-1, flange plate ISO 5211

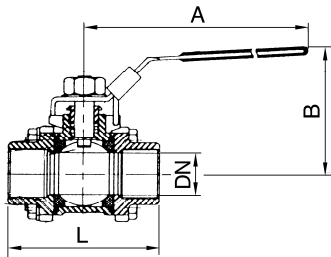

3390.05

**Stainless steel ball valve, 3-piece, length acc. to DIN 3202-M3, with full bore**

Art. No.	Type No.	Thread	DN	PN bar	L mm	A mm	B mm	ISO 5211
135910	3390.01	G 1/4	11.6	63	50.0	143.0	70.0	F 03 / F 04
135911	3390.02	G 3/8	12.5	63	60.0	143.0	70.0	F 03 / F 04
135912	3390.03	G 1/2	15	63	75.0	143.0	70.0	F 03 / F 04
135913	3390.04	G 3/4	20	63	80.0	143.0	79.0	F 03 / F 04
135914	3390.05	G 1	25	63	90.0	163.0	95.0	F 04 / F 05
135915	3390.06	G 1 1/4	32	63	110.0	163.0	95.0	F 04 / F 05
135916	3390.07	G 1 1/2	38	63	120.0	188.0	116.0	F 05 / F 07
135917	3390.08	G 2	50	63	140.0	188.0	124.0	F 05 / F 07
135918	3390.09	G 2 1/2	64	40	185.0	350.0	141.0	F 07 / F 10
135919	3390.10	G 3	76	40	205.0	350.0	149.0	F 07 / F 10

