

Angle-seat type, stainless steel

Body and valve trim:	Stainless steel 1.4401/1.4408
Sealant:	FKM
Opening pressure:	Min. 0.2 bar
Working pressure:	Max. 40.0 bar
Medium temperature:	180 °C
Ambient temperature:	180 °C
Operating temperature:	-29 °C to 180 °C
Thread:	G thread acc. to DIN EN ISO 228-1

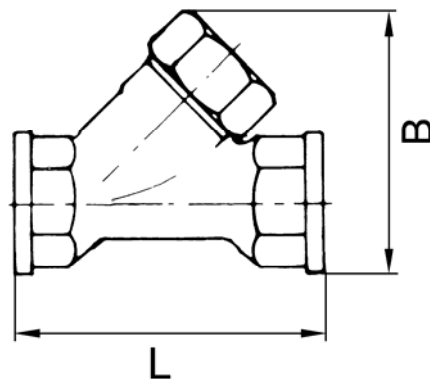

220.05-ES



Unidirectional valves

Art. No.	Ident No.	Thread	a/f	B	L	No. of set of wearing parts
220.01-ES	103832	G 1/4	27	53.5	66.0	22.2235.4
220.02-ES	103833	G 3/8	27	53.5	66.0	22.2235.4
220.03-ES	103834	G 1/2	27	53.5	66.0	22.2235.4
220.04-ES	103835	G 3/4	32	68.0	76.0	22.2245.4
220.05-ES	103836	G 1	40	82.0	90.0	22.2255.4
220.06-ES	103837	G 1 1/4	50	97.0	110.0	22.2265.4
220.07-ES	103838	G 1 1/2	55	113.0	121.0	22.2275.4
220.08-ES	103839	G 2	70	131.0	151.0	22.2285.4