

»4H« Series

514.1000–514.2003

Symbol

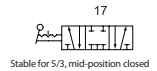

Product features

Traditional and robust valve series. Suitable for all applications where pneumatic actuators have to be operated. These valves are designed for in-line installation. Mounting in any position.

The following types are available:

- Three port sizes (1/8", 1/4" and 3/8")
- 5/2 and 5/3-way versions

Valve's specification

Art. No.	Size 200				Size 300			
	514.1000	514.2000	514.1001	514.2001	514.1002	514.2002	514.1003	514.2003
Fluid	Air (to be filtered by $\leq 40 \mu\text{m}$ filter element)							
Operating	Manual control direct acting type							
Port size	In = Out		In = Out = 1/4"		In = Out		In = Out = 3/8"	
	= Exhaust = 1/8"		Exhaust = 1/8"		Exhaust = 1/4"		Exhaust = 1/4"	
Valid area of section	14.0 mm ²	12.0 mm ²	16.0 mm ²	12.0 mm ²	25.0 mm ²	18.0 mm ²	30.0 mm ²	18.0 mm ²
Valve type	5/2-way	5/3-way	5/2-way	5/3-way	5/2-way	5/3-way	5/2-way	5/3-way
Lubrication	Not required							
Pressure range	0 to 8 bar (0 to 0.8 MPa; 0 to 116 psi)							
Proof pressure	15 bar (1.5 MPa; 215 psi)							
Temperature	-20 to 70 °C							
Material of body	Aluminium alloy							
Flow rate measurement at $P_1 = 8 \text{ bar}$, $P_2 = 6 \text{ bar}$ and pressure drop $\Delta p = 1 \text{ bar}$	750 L/min	750 L/min	850 L/min	850 L/min	1300 L/min	1300 L/min	1500 L/min	1500 L/min

Port identification pneumatic valves

	Designation at the valve	Corresponds to ISO 1219-1
Input port	P	1
Output port	A	2
Output port	B	4
Exhaust port	R	3
Exhaust port	S	5
Control port	Y	12
Control port	Z	14

Ordering information

Art. No.	Type
514.1000, 514.1003	5/2-way valve, operated by hand lever, latching
514.2000, 514.2003	5/3-way valve, operated by hand lever, MID-position closed, latching

»4H« Series

514.1000–514.2003

Flow chart

514.1001 (G 1/8")

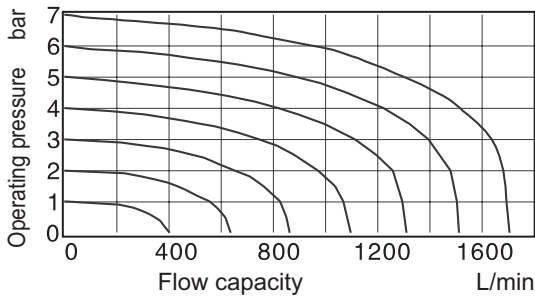

514.1003 (G 1/4")

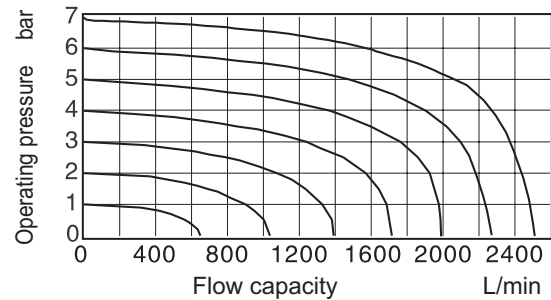

Dimensions

514.1000–514.1003 (5/2-way)

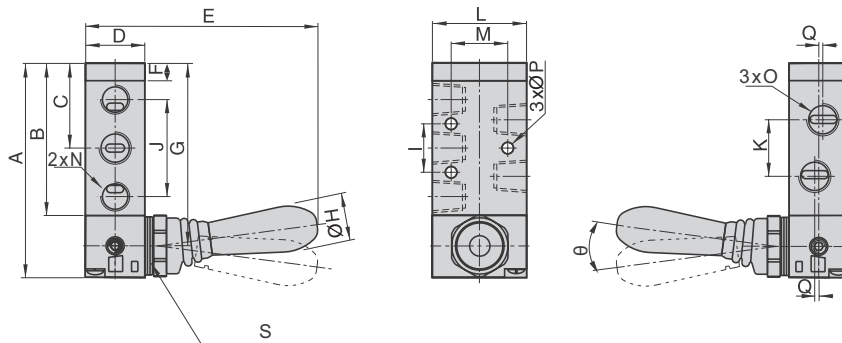

Art. No.	A	B	C	D	E	F	G	H	I	J	K	L	M	N	O	P	Q	θ	S
514.1000	81.5	57.5	32.5	22	90	7.5	69.5	18	20	36	18	35	23.5	1/8"	1/8"	4.3	-	15	M16x1.5
514.1001	81.5	57.5	32.5	22	90	7.5	69.5	18	20	36	21	35	23.5	1/8"	1/4"	4.3	1.5	15	M16x1.5
514.1002	101	73	40.5	27	93.5	8	87	18	24	45	22	40	27.5	1/4"	1/4"	4.3	-	18	M20x1.5
514.1003	101	73	40.5	27	93.5	8	87	18	24	45	24	40	27.5	1/4"	3/8"	4.3	2	18	M20x1.5

(Values in mm, exception N, O = inch)

514.2000–514.2003 (5/3-way)

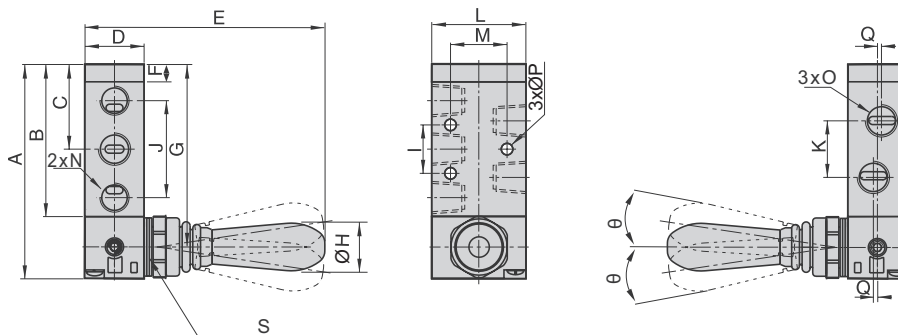

Art. No.	A	B	C	D	E	F	G	H	I	J	K	L	M	N	O	P	Q	θ	S
514.2000	81.5	57.5	32.5	22	90.5	7.5	69.5	18	20	36	18	35	23.5	1/8"	1/8"	4.3	-	8.5	M16x1.5
514.2001	81.5	57.5	32.5	22	90.5	7.5	69.5	18	20	36	21	35	23.5	1/8"	1/4"	4.3	1.5	8.5	M16x1.5
514.2002	101	73	40.5	27	94	8	87	18	24	45	22	40	27.5	1/4"	1/4"	4.3	-	10	M20x1.5
514.2003	101	73	40.5	27	94	8	87	18	24	45	24	40	27.5	1/4"	3/8"	4.3	2	10	M20x1.5

(Values in mm, exception N, O = inch)

»4H« Series

514.1000–514.2003

Components and materials

5/2-way and 5/3-way

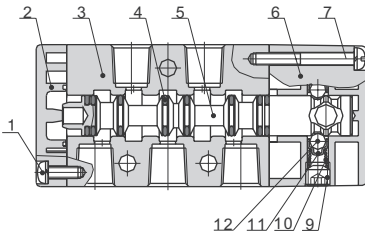

No.	Item	Material
1	Screw	Steel
2	Cover	Aluminium alloy
3	Body	Aluminium alloy
4	O-ring	HNBR
5	Spool	Aluminium alloy
6	Cover	Aluminium alloy
7	Screw	Steel
8	Axle	Steel
9	Screw	Steel
10	Spring	Stainless steel
11	Steel ball jacket	POM
12	Steel ball	Steel

Mounting

Body mounting

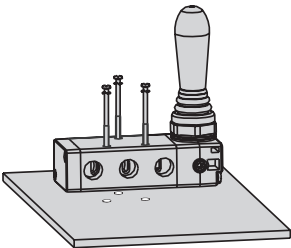

Panel mounting

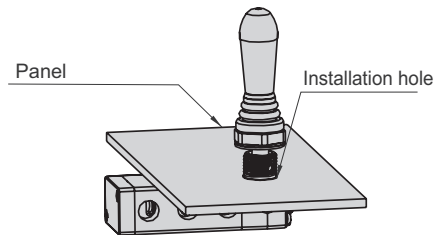

Art. No.	514.1000, 514.1001 514.2000, 514.2001	514.1002, 514.1003 514.2002, 514.2003
Panel thickness	≤5 mm	≤6 mm
Diameter of installation hole	Ø 16.5	Ø 20.5

Ordering information

Art. No.	Ident No.
514.1000	115964
514.1001	115965
514.1002	115966
514.1003	115967
514.2000	115968
514.2001	115969
514.2002	115970
514.2003	115971