

Made of PTFE.

Temperature range: max. +260 °C

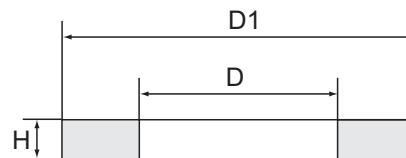

258.45



### Sealing rings, PTFE

Art. No.	Ident No.	For thread	D	D1	H
258.40	114109	M5	5.1 ±0.1	8.0 ±0.1	1.0 ±0.05
258.41	114110	G 1/8	10.0 ±0.15	13.0 ±0.15	1.5 ±0.2
258.42	114111	G 1/4	13.2 ±0.3	18.0 ±0.3	1.5 ±0.2
258.43	114112	G 3/8	16.8 ±0.15	22.0 ±0.15	1.5 ±0.2
258.44	114113	G 1/2	21.0 ±0.15	28.0 ±0.15	1.5 ±0.2
258.45	114114	G 3/4	26.5 ±0.15	33.0 ±0.15	2.0 ±0.2
258.46	114115	G 1	33.3 ±0.15	38.9 ±0.15	2.0 ±0.2