

Lockable, with relief port.

Stainless steel safety ball valves. Specially designed for pneumatic applications. The ball valve can be locked manually and has a relief port.

Housing	Stainless steel 1.4408
Ball	Stainless steel 1.4408
Hand lever	Stainless steel 1.4301, PVC coated
Ball seal	PTFE
Stem seal	PTFE
Operating temperature	-20 °C to 160 °C
Max. operating pressure	17 bar
Standard thread	G thread acc. to DIN EN ISO 228-1
Relief port	M5

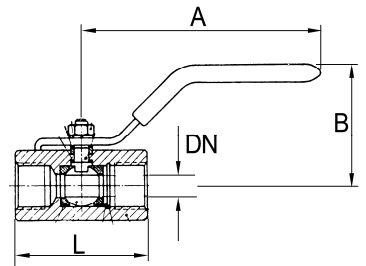

Stainless steel safety ball valve, lockable, with relief port

Art. No.	Type No.	Thread	DN	L mm	A mm	B mm
151730	3396.02	G 1/4	11.5	54.4	103.9	50.0
151731	3396.03	G 3/8	12.5	54.4	103.9	50.0
151732	3396.04	G 1/2	15	65.3	123.0	56.5
151733	3396.05	G 3/4	20	75.0	123.0	60.5
151734	3396.06	G 1	25	88.7	145.0	69.3



3396.06*

- ➔ Regardless of the 1000 WOG (PN 63) operating pressure marked on the device, the relief valve must not be operated at more than PN 17 bar. We recommend fitting the relief port with a silencer (M5 connection).

* The images maybe different from the original part