

Standard type with L-bore.

3-way ball valves with full bore for diverting media. Applications: Water, non-toxic gases, plumbing and heating systems, oils, general industrial applications, diesel fuel.

Housing	Nickel-plated brass
Internal parts	Nickel-plated brass
Sealant	PTFE
Hand lever	Aluminium, painted black
Medium temperature	-10 °C to 120 °C
Ambient temperature	-10 °C to 120 °C
Thread material	Brass with a bare metal surface
Standard thread	Rp thread acc. to ISO 7-1

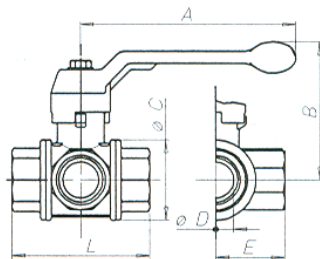

3-way ball valve, standard type, L-bore

Art. No.	Type No.	Thread	DN	PN bar	A mm	B mm	L mm	E mm	Ø C mm	Ø D mm	Weight kg
103375	1081 A	Rp 1/4	8	40	100.0	61.0	52.0	26.0	29.0	10.0	0.276
103376	1081 B	Rp 3/8	10	40	100.0	61.0	55.0	27.0	29.0	10.0	0.263
103377	1081 C	Rp 1/2	15	40	100.0	64.0	69.0	33.0	36.0	14.0	0.405
103378	1081 D	Rp 3/4	20	40	120.0	76.0	77.0	38.0	45.0	19.0	0.686
103379	1081 E	Rp 1	25	40	120.0	80.0	89.0	46.0	54.0	24.0	0.993
103380	1081 F	Rp 1 1/4	32	10	150.0	98.0	103.0	54.0	65.0	30.5	1.728
103381	1081 G	Rp 1 1/2	40	10	150.0	104.0	114.0	61.0	79.0	38.5	2.448
103382	1081 H	Rp 2	50	10	175.0	119.0	134.0	73.0	96.0	48.5	4.014

The following valve positions can be achieved by rotating the lever 90°!

