

Non-lockable, with relief port.

Safety brass ball valves. Specially designed for pneumatic applications.  
 The ball valve shuts off the supply side and relieves the application into the atmosphere.

Body, ball, stem, stuffing box  
 Hand lever  
 Seal  
 Operating temperature  
 Thread

Nickel-plated brass  
 Die-cast aluminium, black  
 PTFE  
 0 °C to +60 °C  
 Rp thread acc. to ISO 7-1

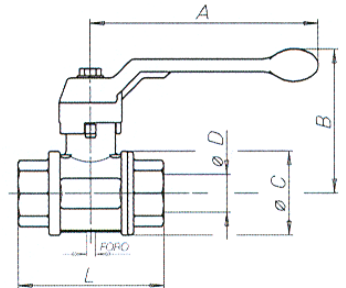

### Safety ball valves, non-lockable, with relief port

Art. No.	Ident No.	Thread	DN	A mm	B mm	Ø C mm	Ø D mm	L mm	Weight gr.	max. operating pressure at 20 °C bar
350.501	103253	Rp 1/4	8	100.0	61.0	29.0	10.0	52.0	245.0	12
350.502	103254	Rp 3/8	10	100.0	61.0	29.0	10.0	55.0	245.0	12
350.503	103255	Rp 1/2	15	100.0	64.0	36.0	15.0	69.0	370.0	12
350.504	103256	Rp 3/4	20	120.0	76.0	45.0	20.0	77.0	635.0	12
350.505	103257	Rp 1	25	120.0	80.0	54.0	25.0	89.0	890.0	12
350.506	103258	Rp 1 1/4	32	150.0	98.0	65.0	32.0	103.0	1550.0	12
350.507	103259	Rp 1 1/2	40	150.0	104.0	79.0	40.0	114.0	2300.0	12
350.508	103260	Rp 2	50	175.0	119.0	96.0	50.0	134.0	3630.0	12

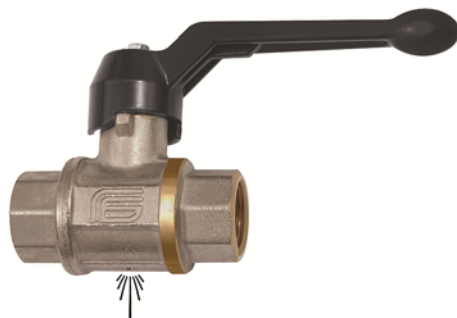

350.503

