

For panel mounting

Body and ball:	Chrome plated-brass
Rotating handle:	PA 66 glass fibre-reinforced
Ball seals:	PTFE
Stem seal:	NBR
Operating temperature:	-20 °C to +80 °C
Operating pressure:	-0,99 bar to 20 bar
Thread:	G thread acc. to DIN EN ISO 228-1
Applications:	Compressed air, water, oil

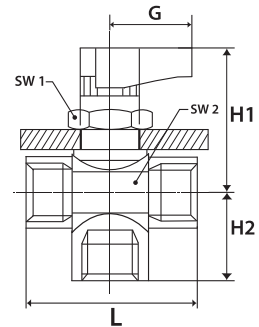

3-way mini ball valves, L-Bore

Art. No.	Ident No.	Thread	DN	a/f 1 mm	a/f 2 mm	L mm	G mm	H1 mm	H2 mm	S max. mm	P mm
381.01	103363	G 1/8 female	5	17	17	35.0	19.0	33.5	15.5	4.5	14.5
381.02	103364	G 1/4 female	5	17	17	37.0	19.0	33.5	17.5	4.5	14.5
381.03	103365	G 3/8 female	7	17	21	42.0	19.0	35.0	19.5	4.5	14.5

3-way mini ball valves, T-Bore

Art. No.	Ident No.	Thread	DN	a/f 1 mm	a/f 2 mm	L mm	G mm	H1 mm	H2 mm	S max. mm	P mm
382.01	103366	G 1/8 female	5	17	17	35.0	19.0	33.5	15.5	4.5	14.5
382.02	103367	G 1/4 female	5	17	17	37.0	19.0	33.5	17.5	4.5	14.5
382.03	103368	G 3/8 female	7	17	21	42.0	19.0	35.0	19.5	4.5	14.5

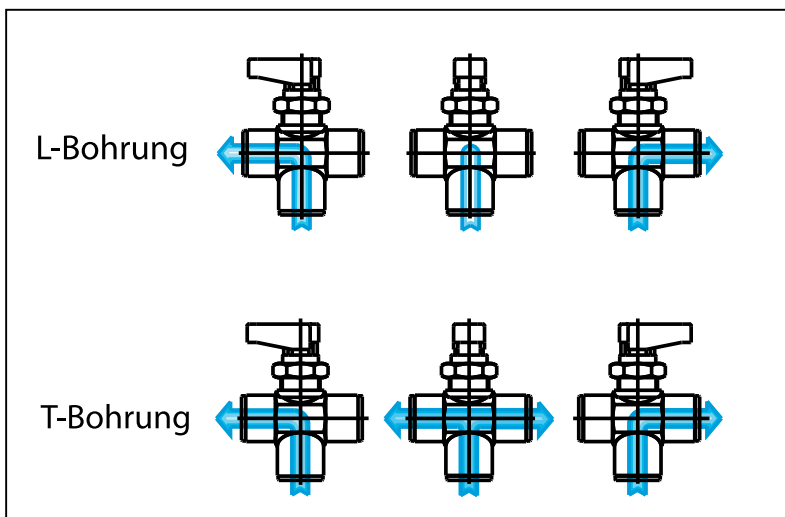

381.02