

Made of copper.

Temperature range: max. +250 °C

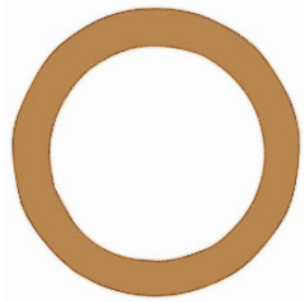

258.33

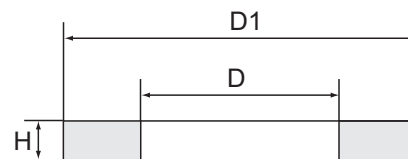

Sealing rings, copper

Art. No.	Ident No.	For thread	D	D1	H
258.30	114102	M5	5.2 ±0.2	8.0 ±0.2	1.0 ±0.1
258.31	114103	G 1/8	10.2 +0.3/0	13.4 0/-0.2	1.5 ±0.2
258.32	114104	G 1/4	13.2 +0.3/0	17.9 0/-0.2	1.5 ±0.2
258.33	114105	G 3/8	16.8 ±0.2	22.0 ±0.2	1.5 ±0.1
258.34	114106	G 1/2	21.2 +0.3/0	27.9 0/-0.2	1.5 ±0.2
258.35	114107	G 3/4	26.5 ±0.2	33.0 ±0.3	2.0 ±0.1
258.36	114108	G 1	33.3 +0.3/0	38.9 0/-0.2	2.0 ±0.2