

Push-in fittings. manufactured entirely in nickel-plated brass.

All parts with a parallel thread are supplied with an FPM O-ring while the conical threads are coated with preCOTE 5 dispersion; all fittings in this series can thus also be used at high temperatures (medium compressed air).

| | |
|------------------------|---------------------|
| Working pressure: | max. 16 bar |
| Operating temperature: | -20 °C to +150 °C |
| Material: | Nickel-plated brass |
| Sleeve: | Nickel-plated brass |
| Clamping ring: | stainless steel |
| O-ring: | FPM |

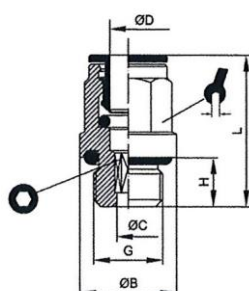

845.014-6

Male connector, parallel male thread with O-ring and outer hex (M-thread without outer hex)

| Type No. | Art. No. | Ø D mm | Thread | Ø B mm | Ø C mm | H mm | L mm | mm | mm |
|------------|----------|-----------|--------|-----------|-----------|---------|---------|-------|-----|
| 845.005-4 | 108854 | 4 | M5 | 9.0 | 2.6 | 4.0 | 20.5 | Ø9 | 2.5 |
| 845.005-6 | 108855 | 6 | M5 | 10.5 | 2.6 | 4.0 | 22.5 | Ø10.5 | 2.5 |
| 845.018-4 | 108856 | 4 | G 1/8 | 13.5 | 2.6 | 6.0 | 20.0 | 9 | 2.5 |
| 845.018-6 | 108857 | 6 | G 1/8 | 13.5 | 4.2 | 6.0 | 24.0 | 11 | 4 |
| 845.018-8 | 108858 | 8 | G 1/8 | 12.8 | 5.2 | 6.0 | 26.5 | 13 | 5 |
| 845.018-10 | 108859 | 10 | G 1/8 | 13.5 | 5.2 | 6.0 | 29.0 | 16 | 5 |
| 845.014-4 | 108860 | 4 | G 1/4 | 17.0 | 2.6 | 8.0 | 21.0 | 9 | 2.5 |
| 845.014-6 | 108861 | 6 | G 1/4 | 17.0 | 4.2 | 8.0 | 24.0 | 11 | 4 |
| 845.014-8 | 108862 | 8 | G 1/4 | 17.0 | 6.2 | 8.0 | 25.0 | 13 | 6 |
| 845.014-10 | 108863 | 10 | G 1/4 | 16.0 | 7.3 | 8.0 | 29.0 | 16 | 7 |
| 845.014-12 | 108864 | 12 | G 1/4 | 16.0 | 7.3 | 6.5 | 30.0 | 18 | 7 |
| 845.038-8 | 108865 | 8 | G 3/8 | 20.0 | 6.2 | 9.0 | 25.0 | 13 | 6 |
| 845.038-10 | 108866 | 10 | G 3/8 | 21.0 | 8.3 | 9.0 | 29.5 | 16 | 8 |
| 845.038-12 | 108867 | 12 | G 3/8 | 21.0 | 10.3 | 9.0 | 31.0 | 18 | 10 |
| 845.038-14 | 108868 | 14 | G 3/8 | 21.0 | 10.3 | 9.0 | 34.0 | 21 | 10 |
| 845.038-16 | 136773 | 16 | G 3/8 | 21.0 | 10.3 | 9.0 | 36.0 | 24 | 10 |
| 845.012-10 | 108869 | 10 | G 1/2 | 24.0 | 8.3 | 11.0 | 31.0 | 16 | 8 |
| 845.012-12 | 108870 | 12 | G 1/2 | 24.0 | 10.3 | 11.0 | 31.5 | 18 | 10 |
| 845.012-14 | 108871 | 14 | G 1/2 | 25.0 | 12.3 | 11.0 | 34.5 | 21 | 12 |
| 845.012-16 | 136774 | 16 | G 1/2 | 24.0 | 12.3 | 11.0 | 37.5 | 24 | 12 |

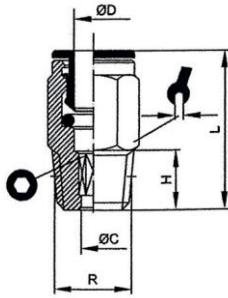

844.018-6

Male connector, conical male thread, coated with outer hex

| Type No. | Art. No. | Ø D mm | Thread | Ø C mm | H mm | L mm | mm | mm |
|------------|----------|--------|--------|--------|------|------|----|-----|
| 844.018-4 | 108882 | 4 | R 1/8 | 2.6 | 7.0 | 22.5 | 10 | 2.5 |
| 844.018-6 | 108883 | 6 | R 1/8 | 4.2 | 7.0 | 24.5 | 11 | 4 |
| 844.018-8 | 108884 | 8 | R 1/8 | 5.2 | 7.0 | 27.5 | 13 | 5 |
| 844.014-4 | 108885 | 4 | R 1/4 | 2.6 | 11.0 | 22.5 | 14 | 2.5 |
| 844.014-6 | 108886 | 6 | R 1/4 | 4.2 | 11.0 | 24.5 | 14 | 4 |
| 844.014-8 | 108887 | 8 | R 1/4 | 5.2 | 11.0 | 27.5 | 13 | 5 |
| 844.014-10 | 108888 | 10 | R 1/4 | 7.3 | 11.0 | 32.5 | 16 | 7 |
| 844.014-12 | 108889 | 12 | R 1/4 | 7.3 | 11.0 | 32.5 | 17 | 7 |
| 844.038-8 | 108890 | 8 | R 3/8 | 5.2 | 11.5 | 28.0 | 17 | 5 |
| 844.038-10 | 108891 | 10 | R 3/8 | 8.3 | 11.5 | 32.5 | 17 | 8 |
| 844.038-12 | 108892 | 12 | R 3/8 | 8.3 | 11.5 | 30.5 | 17 | 8 |
| 844.012-12 | 108893 | 12 | R 1/2 | 10.3 | 14.0 | 33.0 | 22 | 10 |

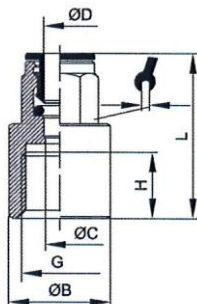

846.014-6

Male connector, parallel female thread with outer hex

| Type No. | Art. No. | Ø D mm | Thread | Ø B mm | Ø C mm | H mm | L mm | mm |
|------------|----------|--------|--------|--------|--------|------|------|----|
| 846.018-4 | 108872 | 4 | G 1/8 | 12.0 | 3.0 | 6.5 | 26.5 | 9 |
| 846.018-6 | 108873 | 6 | G 1/8 | 12.0 | 5.0 | 6.5 | 27.0 | 11 |
| 846.018-8 | 108874 | 8 | G 1/8 | 12.0 | 7.0 | 6.5 | 28.0 | 13 |
| 846.014-4 | 108875 | 4 | G 1/4 | 17.0 | 3.0 | 10.0 | 29.5 | 9 |
| 846.014-6 | 108876 | 6 | G 1/4 | 17.0 | 5.0 | 10.0 | 31.0 | 11 |
| 846.014-8 | 108877 | 8 | G 1/4 | 17.0 | 7.0 | 10.0 | 32.0 | 13 |
| 846.014-10 | 108878 | 10 | G 1/4 | 16.0 | 9.0 | 10.0 | 32.0 | 16 |
| 846.014-12 | 108879 | 12 | G 1/4 | 20.0 | 11.0 | 15.0 | 40.0 | 20 |
| 846.038-10 | 108880 | 10 | G 3/8 | 20.0 | 9.0 | 13.0 | 37.5 | 20 |
| 846.038-12 | 108881 | 12 | G 3/8 | 20.0 | 11.0 | 15.0 | 39.5 | 20 |
| 846.012-16 | 136775 | 16 | G 1/2 | 24.0 | 14.5 | 15.0 | 41.0 | 24 |

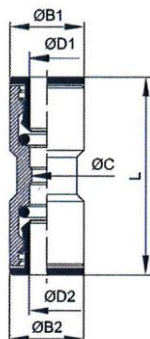

847.006

Union

| Type No. | Art. No. | Ø D1 mm | Ø D2 mm | Ø B1 mm | Ø B2 mm | Ø C mm | L mm |
|----------|----------|------------|------------|------------|------------|-----------|---------|
| 847.004 | 108966 | 4 | 4 | 9.0 | 9.0 | 3.0 | 31.0 |
| 847.006 | 108967 | 6 | 6 | 11.0 | 11.0 | 5.0 | 33.0 |
| 847.008 | 108968 | 8 | 8 | 13.0 | 13.0 | 7.0 | 37.0 |
| 847.010 | 108969 | 10 | 10 | 15.0 | 15.0 | 9.0 | 39.0 |
| 847.012 | 108970 | 12 | 12 | 17.0 | 17.0 | 11.0 | 43.0 |
| 847.014 | 108971 | 14 | 14 | 20.0 | 20.0 | 12.0 | 48.0 |
| 847.016 | 136779 | 16 | 16 | 24.0 | 24.0 | 14.0 | 50.0 |

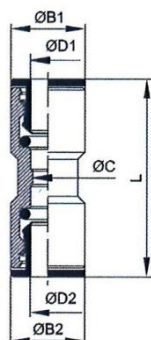

847.1008

Reducer

| Type No. | Art. No. | Ø D1 mm | Ø D2 mm | Ø B1 mm | Ø B2 mm | Ø C mm | L mm |
|----------|----------|------------|------------|------------|------------|-----------|---------|
| 847.0604 | 108972 | 6 | 4 | 11.0 | 9.0 | 3.0 | 33.0 |
| 847.0806 | 108973 | 8 | 6 | 13.0 | 11.0 | 5.0 | 39.0 |
| 847.1008 | 108974 | 10 | 8 | 16.0 | 13.0 | 7.0 | 39.0 |
| 847.1210 | 108975 | 12 | 10 | 20.0 | 15.0 | 9.0 | 42.5 |

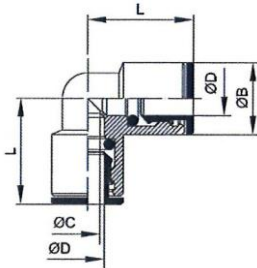

848.006

Union elbow

| Type No. | Art. No. | Ø D mm | Ø B mm | Ø C mm | L mm |
|----------|----------|--------|--------|--------|------|
| 848.004 | 108982 | 4 | 9.0 | 3.0 | 17.5 |
| 848.006 | 108983 | 6 | 11.0 | 5.0 | 20.0 |
| 848.008 | 108984 | 8 | 13.0 | 7.0 | 23.0 |
| 848.010 | 108985 | 10 | 15.0 | 8.0 | 25.0 |
| 848.012 | 108986 | 12 | 17.0 | 10.0 | 27.5 |
| 848.014 | 108987 | 14 | 20.0 | 12.0 | 31.0 |
| 848.016 | 136781 | 16 | 23.0 | 14,0 | 33.0 |

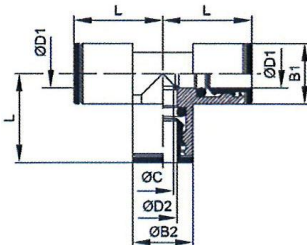

849.006

Union tee

| Type No. | Art. No. | Ø D1 mm | Ø D2 mm | Ø B1 mm | Ø B2 mm | Ø C mm | L1 mm | L2 mm |
|----------|----------|---------|---------|---------|---------|--------|-------|-------|
| 849.004 | 108988 | 4 | 4 | 9.0 | 9.0 | 3.0 | 34.0 | 17.0 |
| 849.006 | 108989 | 6 | 6 | 11.0 | 11.0 | 5.0 | 39.0 | 19.5 |
| 849.008 | 108990 | 8 | 8 | 13.0 | 13.0 | 7.0 | 46.0 | 23.0 |
| 849.010 | 108991 | 10 | 10 | 15.0 | 15.0 | 8.0 | 50.0 | 25.0 |
| 849.012 | 108992 | 12 | 12 | 17.0 | 17.0 | 10.0 | 54.0 | 27.0 |
| 849.014 | 108993 | 14 | 14 | 20.0 | 20.0 | 12.0 | 62.0 | 31.0 |
| 849.016 | 136782 | 16 | 16 | 23.0 | 23.0 | 14.5 | 72.0 | 36.0 |

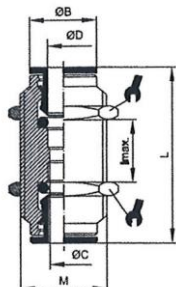

851.016-8

Female bulkhead connector

| Type No. | Art. No. | Ø D mm | Ø C mm | Thread | Ø B mm | l _{max} | L mm |  mm |
|------------|----------|-----------|-----------|---------|-----------|------------------|---------|---|
| 851.010-4 | 108976 | 4 | 3.0 | M10x1.0 | 8.0 | 15.0 | 31.5 | 13 |
| 851.014-6 | 108977 | 6 | 5.0 | M14x1.0 | 11.0 | 11.0 | 33.5 | 17 |
| 851.016-8 | 108978 | 8 | 7.0 | M16x1.0 | 13.0 | 16.0 | 37.0 | 18 |
| 851.017-10 | 108979 | 10 | 9.0 | M17x1.0 | 15.0 | 19.0 | 39.5 | 20 |
| 851.020-12 | 108980 | 12 | 11.0 | M20x1.0 | 17.0 | 17.0 | 42.0 | 24 |
| 851.022-14 | 108981 | 14 | 13.0 | M22x1.0 | 20.0 | 21.0 | 46.0 | 25 |
| 851.028-16 | 136780 | 16 | 14.5 | M28x1.5 | 24.0 | 22.0 | 50.0 | 36 |

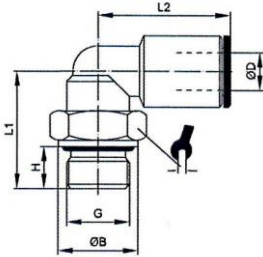

854.014-6

Male elbow, swivel type, parallel male thread with O-ring

| Type No. | Art. No. | Ø D mm | Thread | Ø B mm | H mm | L1 mm | L2 mm |  mm |
|------------|----------|--------|--------|--------|------|-------|-------|--|
| 854.005-4 | 108894 | 4 | M5 | 8.0 | 4.0 | 14.5 | 18.0 | 9 |
| 854.005-6 | 108895 | 6 | M5 | 8.0 | 4.0 | 14.5 | 21.0 | 9 |
| 854.018-4 | 108896 | 4 | G 1/8 | 13.0 | 6.0 | 20.0 | 20.0 | 13 |
| 854.018-6 | 108897 | 6 | G 1/8 | 13.0 | 6.0 | 20.0 | 21.0 | 13 |
| 854.018-8 | 108898 | 8 | G 1/8 | 13.0 | 6.0 | 20.0 | 24.0 | 13 |
| 854.018-10 | 136776 | 10 | G 1/8 | 13.0 | 5.5 | 23.5 | 26.5 | 13 |
| 854.014-4 | 108899 | 4 | G 1/4 | 16.0 | 8.0 | 24.0 | 20.0 | 13 |
| 854.014-6 | 108900 | 6 | G 1/4 | 16.0 | 8.0 | 24.0 | 21.0 | 13 |
| 854.014-8 | 108901 | 8 | G 1/4 | 16.0 | 8.0 | 24.0 | 24.0 | 13 |
| 854.014-10 | 108902 | 10 | G 1/4 | 16.0 | 8.0 | 24.0 | 27.0 | 16 |
| 854.014-12 | 108903 | 12 | G 1/4 | 16.0 | 6.5 | 29.0 | 30.5 | 16 |
| 854.038-8 | 108904 | 8 | G 3/8 | 20.0 | 9.0 | 25.5 | 24.0 | 13 |
| 854.038-10 | 108905 | 10 | G 3/8 | 20.0 | 9.0 | 28.0 | 27.0 | 16 |
| 854.038-12 | 108906 | 12 | G 3/8 | 20.0 | 9.0 | 29.0 | 29.0 | 20 |
| 854.038-14 | 137008 | 14 | G 3/8 | 19.8 | 9.0 | 28.5 | 32.0 | 20 |
| 854.038-16 | 136777 | 16 | G 3/8 | 19.8 | 9.0 | 33.0 | 33.5 | 20 |
| 854.012-10 | 108907 | 10 | G 1/2 | 25.0 | 11.0 | 30.0 | 27.0 | 16 |
| 854.012-12 | 108908 | 12 | G 1/2 | 25.0 | 11.0 | 35.0 | 29.0 | 20 |
| 854.012-14 | 137009 | 14 | G 1/2 | 25.0 | 11.0 | 35.0 | 32.0 | 20 |
| 854.012-16 | 136778 | 16 | G 1/2 | 25.0 | 11.0 | 38.0 | 33.5 | 20 |

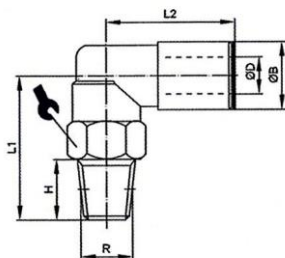

8854.014-6

Male elbow, swivel type, conical male thread, coated

| Type No. | Art. No. | Ø D mm | Thread | H mm | L1 mm | L2 mm |  mm |
|-------------|----------|-----------|--------|---------|----------|----------|---|
| 8854.018-4 | 108909 | 4 | R 1/8 | 7.0 | 20.0 | 20.0 | 13 |
| 8854.018-6 | 108910 | 6 | R 1/8 | 7.0 | 20.0 | 21.0 | 13 |
| 8854.018-8 | 108911 | 8 | R 1/8 | 7.0 | 20.0 | 24.0 | 13 |
| 8854.014-4 | 108912 | 4 | R 1/4 | 11.0 | 25.0 | 20.0 | 14 |
| 8854.014-6 | 108913 | 6 | R 1/4 | 11.0 | 25.0 | 21.0 | 14 |
| 8854.014-8 | 108914 | 8 | R 1/4 | 11.0 | 25.0 | 24.0 | 14 |
| 8854.014-10 | 108915 | 10 | R 1/4 | 11.0 | 26.0 | 27.0 | 16 |
| 8854.038-8 | 108916 | 8 | R 3/8 | 11.0 | 28.0 | 24.0 | 18 |
| 8854.038-10 | 108917 | 10 | R 3/8 | 11.0 | 30.0 | 27.0 | 18 |
| 8854.038-12 | 108918 | 12 | R 3/8 | 11.0 | 32.5 | 28.5 | 20 |
| 8854.038-14 | 137010 | 14 | R 3/8 | 14.0 | 35.5 | 32.0 | 22 |
| 8854.012-12 | 108919 | 12 | R 1/2 | 14.0 | 35.5 | 28.5 | 22 |
| 8854.012-14 | 137011 | 14 | R 1/2 | 14.0 | 35.5 | 32.0 | 22 |

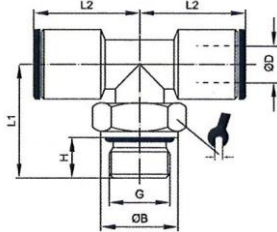

855.014-6

Male branch tee, swivel type, parallel male thread with O-ring

| Type No. | Art. No. | Ø D mm | Thread | Ø B mm | H mm | L1 mm | L2 mm |  mm |
|------------|----------|--------|--------|--------|------|-------|-------|--|
| 855.018-4 | 108920 | 4 | G 1/8 | 13.0 | 6.0 | 20.0 | 20.0 | 13 |
| 855.018-6 | 108921 | 6 | G 1/8 | 13.0 | 6.0 | 20.0 | 21.5 | 13 |
| 855.018-8 | 108922 | 8 | G 1/8 | 13.0 | 6.0 | 20.0 | 23.5 | 13 |
| 855.014-6 | 108923 | 6 | G 1/4 | 16.0 | 8.0 | 24.0 | 21.5 | 13 |
| 855.014-8 | 108924 | 8 | G 1/4 | 16.0 | 8.0 | 24.0 | 23.5 | 13 |
| 855.014-10 | 108925 | 10 | G 1/4 | 16.0 | 8.0 | 24.0 | 26.5 | 16 |
| 855.038-8 | 108926 | 8 | G 3/8 | 20.0 | 9.0 | 25.5 | 23.5 | 13 |
| 855.038-10 | 108927 | 10 | G 3/8 | 20.0 | 9.0 | 28.0 | 26.5 | 16 |
| 855.038-12 | 108928 | 12 | G 3/8 | 19.8 | 9.0 | 34.5 | 29.0 | 20 |
| 855.038-14 | 137012 | 14 | G 3/8 | 19.8 | 9.0 | 28.5 | 32.0 | 20 |
| 855.012-12 | 108929 | 12 | G 1/2 | 25.0 | 11.0 | 34.5 | 29.0 | 20 |
| 855.012-14 | 137013 | 14 | G 1/2 | 25.0 | 11.0 | 33.5 | 32.0 | 20 |

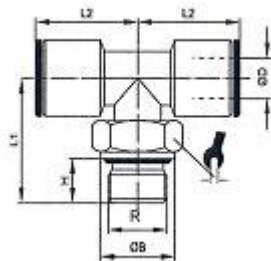

8855.014-6

Male branch tee, swivel type, conical male thread, coated

| Type No. | Art. No. | Ø D mm | Thread | Ø B mm | H mm | L1 mm | L2 mm |  mm |
|-------------|----------|-----------|--------|-----------|---------|----------|----------|---|
| 8855.018-4 | 108930 | 4 | R 1/8 | 12.8 | 7.0 | 20.0 | 20.0 | 13 |
| 8855.018-6 | 108931 | 6 | R 1/8 | 12.8 | 7.0 | 20.0 | 21.5 | 13 |
| 8855.018-8 | 108932 | 8 | R 1/8 | 12.8 | 7.0 | 20.0 | 23.5 | 13 |
| 8855.014-6 | 108933 | 6 | R 1/4 | 14.0 | 11.0 | 25.0 | 21.5 | 14 |
| 8855.014-8 | 108934 | 8 | R 1/4 | 14.0 | 11.0 | 25.0 | 23.5 | 14 |
| 8855.014-10 | 108935 | 10 | R 1/4 | 16.0 | 11.0 | 26.0 | 26.5 | 16 |
| 8855.038-8 | 108936 | 8 | R 3/8 | 18.0 | 11.0 | 28.0 | 23.5 | 18 |
| 8855.038-10 | 108937 | 10 | R 3/8 | 18.0 | 11.0 | 53.0 | 30.0 | 18 |
| 8855.038-12 | 108938 | 12 | R 3/8 | 20.0 | 11.0 | 58.0 | 32.5 | 20 |
| 8855.038-14 | 137014 | 14 | R 3/8 | - | 11.0 | 32.5 | 32.0 | 22 |
| 8855.012-12 | 108939 | 12 | R 1/2 | 22.0 | 14.0 | 58.0 | 35.5 | 22 |
| 8855.012-14 | 137015 | 14 | R 1/2 | - | 14.0 | 35.5 | 32.0 | 22 |

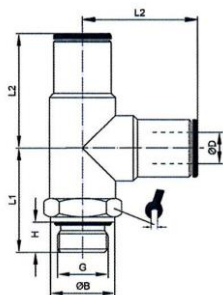

862.014-6

Male branch tee, angled plug connections, swivel type, parallel male thread with O-ring

| Type No. | Art. No. | Ø D mm | Thread | Ø B mm | H mm | L1 mm | L2 mm |  mm |
|------------|----------|--------|--------|--------|------|-------|-------|--|
| 862.018-4 | 108940 | 4 | G 1/8 | 13.0 | 6.0 | 18.0 | 17.5 | 13 |
| 862.018-6 | 108941 | 6 | G 1/8 | 13.0 | 6.0 | 20.5 | 21.0 | 13 |
| 862.018-8 | 108942 | 8 | G 1/8 | 13.0 | 6.0 | 20.0 | 23.0 | 13 |
| 862.014-6 | 108943 | 6 | G 1/4 | 16.0 | 8.0 | 24.5 | 21.0 | 13 |
| 862.014-8 | 108944 | 8 | G 1/4 | 16.0 | 8.0 | 24.5 | 23.0 | 13 |
| 862.014-10 | 108945 | 10 | G 1/4 | 16.0 | 8.0 | 24.0 | 27.0 | 16 |
| 862.038-8 | 108946 | 8 | G 3/8 | 20.0 | 9.0 | 25.7 | 23.4 | 13 |
| 862.038-10 | 108947 | 10 | G 3/8 | 20.0 | 9.0 | 27.0 | 27.0 | 16 |
| 862.038-12 | 108948 | 12 | G 3/8 | 20.0 | 9.0 | 28.0 | 29.0 | 16 |
| 862.038-14 | 137016 | 14 | G 3/8 | 19.8 | 9.0 | 28.5 | 32.0 | 20 |
| 862.012-12 | 108949 | 12 | G 1/2 | 25.0 | 11.0 | 30.0 | 28.5 | 16 |
| 862.012-14 | 137017 | 14 | G 1/2 | 25.0 | 11.0 | 34.0 | 33.0 | 20 |

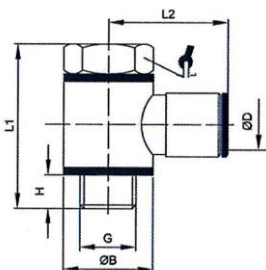

863.018-6

Banjo elbow with outer hex, parallel male thread with O-ring

| Type No. | Art. No. | Ø D mm | Thread | Ø B mm | H mm | L1 mm | L2 mm |  mm |
|------------|----------|--------|--------|--------|------|-------|-------|--|
| 863.005-4 | 108950 | 4 | M5 | SW9 | 3.0 | 17.5 | 18.0 | 8 |
| 863.005-5 | 108951 | 5 | M5 | SW9 | 3.0 | 17.5 | 19.0 | 8 |
| 863.005-6 | 108952 | 6 | M5 | SW9 | 3.0 | 19.5 | 19.5 | 8 |
| 863.018-4 | 108953 | 4 | G 1/8 | 14.0 | 5.5 | 28.0 | 20.5 | 14 |
| 863.018-6 | 108954 | 6 | G 1/8 | 14.0 | 5.5 | 28.0 | 23.0 | 14 |
| 863.018-8 | 108955 | 8 | G 1/8 | 14.0 | 5.5 | 28.0 | 24.5 | 14 |
| 863.014-6 | 108956 | 6 | G 1/4 | 18.0 | 7.0 | 33.0 | 24.0 | 17 |
| 863.014-8 | 108957 | 8 | G 1/4 | 18.0 | 7.0 | 33.0 | 26.0 | 17 |
| 863.014-10 | 108958 | 10 | G 1/4 | 18.0 | 7.0 | 33.0 | 27.0 | 17 |
| 863.038-8 | 108959 | 8 | G 3/8 | 21.0 | 8.5 | 36.0 | 27.0 | 19 |
| 863.038-10 | 108960 | 10 | G 3/8 | 22.0 | 7.5 | 28.0 | 36.5 | 19 |
| 863.038-12 | 108961 | 12 | G 3/8 | 21.0 | 8.5 | 36.0 | 29.0 | 19 |
| 863.012-12 | 108962 | 12 | G 1/2 | 27.0 | 10.0 | 34.5 | 42.0 | 24 |

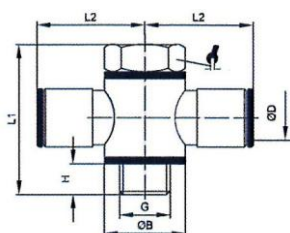

864.018-6

Male branch tee with outer hex, swivel type, parallel male thread with O-ring

| Type No. | Art. No. | Ø D mm | Thread | Ø B mm | H mm | L1 mm | L2 mm |  mm |
|-----------|----------|--------|--------|--------|------|-------|-------|--|
| 864.018-4 | 108963 | 4 | G 1/8 | 14.0 | 5.5 | 28.0 | 21.0 | 14 |
| 864.018-6 | 108964 | 6 | G 1/8 | 14.0 | 5.5 | 28.0 | 23.0 | 14 |
| 864.014-6 | 108965 | 6 | G 1/4 | 18.0 | 7.0 | 33.0 | 24.0 | 17 |

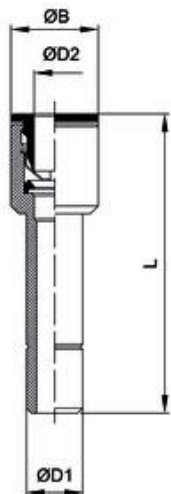

867.0806

Reducer with push-in plug

| Type No. | Art. No. | Ø D1 mm | Ø D2 mm | Ø B mm | L mm |
|----------|----------|------------|------------|-----------|---------|
| 867.0604 | 108994 | 6 | 4 | 9.0 | 29.5 |
| 867.0806 | 108995 | 8 | 6 | 11.0 | 33.0 |
| 867.1008 | 108996 | 10 | 8 | 13.0 | 38.5 |
| 867.1210 | 108997 | 12 | 10 | 15.0 | 41.0 |
| 867.1412 | 137018 | 14 | 12.2 | 17.0 | 44.0 |

Assembling instructions for push-in fittings

- Cut the hose ends plain. To ensure an ideal sealing effect and secure stop of the fitting make sure the hose end is not oval.
- Clean the hose ends and make sure that it is free of burrs.
- Push the hose ends into the fitting till it stops.
- Test stability by pulling the hose shortly.
- Push the release ring to release the hose.
- Pull out the hose with slight rotation.
- For a new assembling cut the hose plain again. Then pushing and releasing the tube should not be affected adversely.

We recommend for improved strength of push-in fittings with **PA** hoses, the following push-in fitting - hose combination:

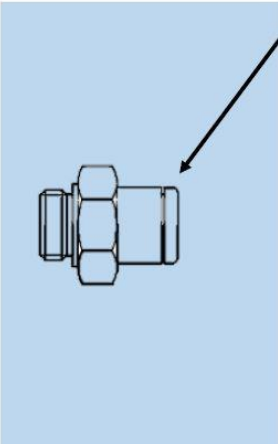

| For tube O.D. | Recommended hose Ø | Recommended hose |
|---------------|--------------------|------------------|
| 3 | 3x1.5 * | 259.08 X |
| 4 | 4x2 * | 259.09 X |
| 5 | 5x3 | 259.10 X |
| 6 | 6x4 * | 259.11 X |
| 8 | 8x6 * | 259.12 X |
| 10 | 10x7 * | 259.61 X |
| 12 | 12x9 * | 259.14 X |
| 14 | 14x11 | 259.62 X |
| 16 | 16x12 | 259.25 X |

* Recommended and based on ISO 14743

We recommend for improved strength of push-in fittings with **PU** hoses, the following push-in fitting - hose combination:

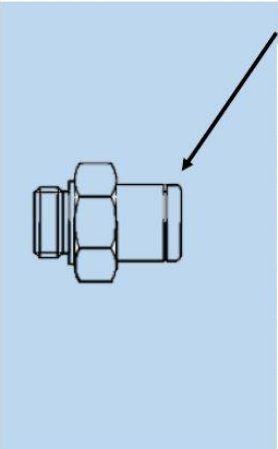

| For tube O.D. | Recommended hose Ø | Recommended hose |
|---------------|--------------------|------------------|
| 3 | 3x1.5 * | 259.50 X |
| 4 | 4x2 * | 259.04 X |
| 5 | 5x3 | 259.15 X |
| 6 | 6x4 * | 259.16 X |
| 8 | 8x5 * | 259.63 X |
| 10 | 10x7 * | 259.64 X |
| 12 | 12x8 * | 259.65 X |
| 14 | 14x10 | 259.51 X |
| 16 | 16x12 | 259.52 X |

* Recommended and based on ISO 14743