

Material: Nickel-plated brass (tube inserts and ferrules brass with a bare metal surface)
 Pressure range: max. 60 bar
 Temperature: max. 150 °C
 Range of use: They are used for pneumatic, oil hydraulic or hydraulic circuits.
 In general, they can be used with all media that are compatible with brass or nickel-plated brass.

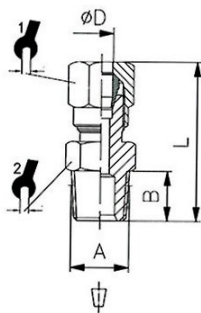

N 29

Male connectors, conical male thread acc. to ISO 7-1

Art. No.	Type No.	ØD mm	Thread A	B mm	L mm	a/f 1 mm	a/f 2 mm
111964	N 21	4	R 1/8	8.0	27.0	10	10
111965	N 23	6	R 1/8	8.0	28.0	12	12
111966	N 24	8	R 1/8	8.0	29.5	14	12
111967	N 28	6	R 1/4	11.0	32.5	12	14
111968	N 29	8	R 1/4	11.0	33.0	14	14
111969	N 30	10	R 1/4	11.0	37.5	19	17
111970	N 34	8	R 3/8	11.5	33.0	14	17
111971	N 35	10	R 3/8	11.5	38.0	19	17
111972	N 36	12	R 3/8	11.5	39.0	22	19
111973	N 39	10	R 1/2	14.0	40.5	19	22
111974	N 40	12	R 1/2	14.0	41.0	22	22
111975	N 41	15	R 1/2	14.0	42.5	27	22
111976	N 42	18	R 1/2	14.0	43.0	32	26

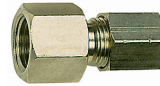
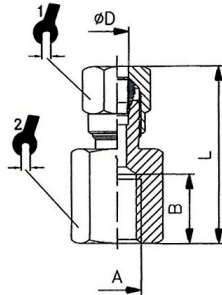

N 64

Pressure gauge fittings with female thread

Art. No.	Type No.	ØD mm	Thread A	B mm	L mm	a/f 1 mm	a/f 2 mm
111977	N 60	4	G 1/8	8.0	24.5	10	14
111978	N 61	6	G 1/8	8.5	25.5	12	14
111979	N 62	8	G 1/8	8.0	26.5	14	14
111980	N 63	6	G 1/4	11.0	30.0	12	17
111981	N 64	8	G 1/4	11.0	31.0	14	17
111982	N 65	10	G 1/4	11.0	35.5	19	17
111983	N 66	8	G 3/8	11.5	31.0	14	20
111984	N 67	10	G 3/8	11.5	36.5	19	20
111985	N 68	12	G 3/8	11.5	36.0	22	20
111986	N 69	12	G 1/2	15.0	39.5	22	24
111987	N 70	15	G 1/2	15.0	40.0	27	24
111988	N 71	18	G 1/2	15.0	42.0	32	26

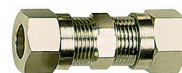
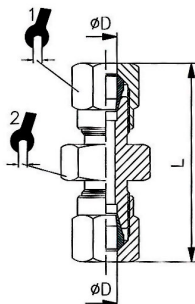

N 55

Unions, pipe connection on both sides

Art. No.	Type No.	ØD mm	L mm	a/f 1 mm	a/f 2 mm
111989	N 50	4	34.0	10	10
111990	N 54	6	35.0	12	12
111991	N 55	8	38.5	14	14
111992	N 56	10	47.5	19	17
111993	N 57	12	48.0	22	19
111994	N 58	15	50.0	27	24
111995	N 59	18	56.0	32	26

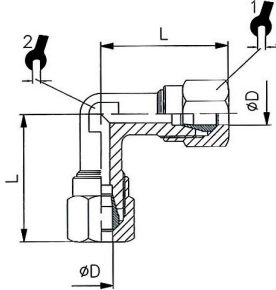

N 75

Union elbows, pipe connection on both sides

Art. No.	Type No.	ØD mm	L mm	a/f 1 mm	a/f 2 mm
111996	N 73	4	21.0	10	9
111997	N 74	6	23.0	12	9
111998	N 75	8	24.0	14	11
111999	N 76	10	32.0	19	13
112000	N 77	12	34.5	22	15
112001	N 78	15	38.0	27	17
112002	N 79	18	44.0	32	22

Banjo elbows, parallel male thread with O-ring



N 84

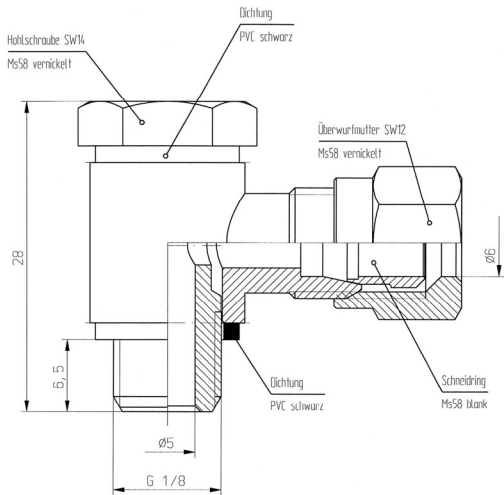

Type No. N 81
Art. No. 112003

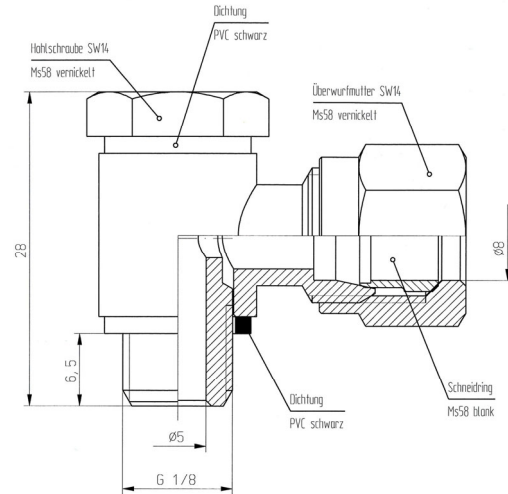

Type No. N 82
Art. No. 112004

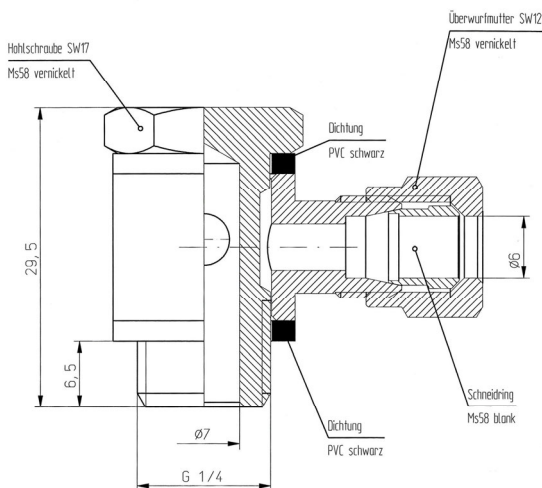

Type No. N 83
Art. No. 112005

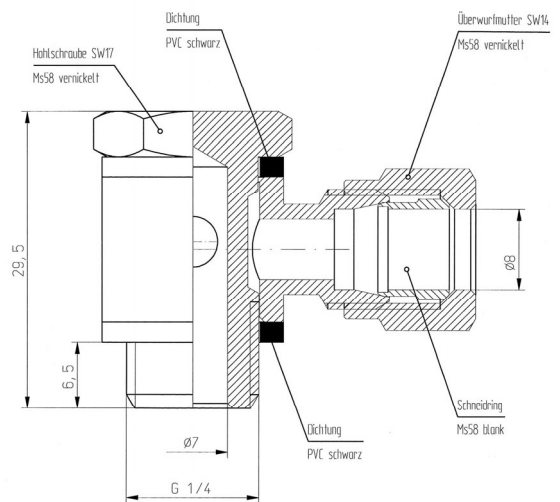

Type No. N 84
Art. No. 112006

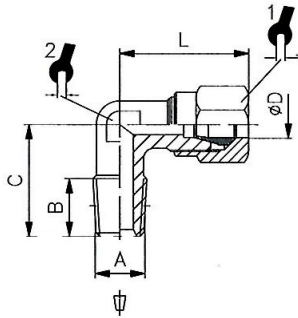

N 93

Male elbows, conical male thread acc. to ISO 7-1

Art. No.	Type No.	ØD mm	Thread A	B mm	C mm	L mm	a/f 1 mm	a/f 2 mm
112007	N 89	4	R 1/8	8.0	16.0	21.0	10	9
112008	N 90	6	R 1/8	8.0	16.0	22.0	12	9
112009	N 91	8	R 1/8	8.0	17.0	24.0	14	11
112010	N 92	6	R 1/4	11.0	20.0	24.5	12	11
112011	N 93	8	R 1/4	11.0	20.0	24.0	14	11
112012	N 94	10	R 1/4	11.0	23.5	32.0	19	13
112013	N 97	8	R 3/8	11.5	24.0	27.0	14	13
112014	N 98	10	R 3/8	11.5	24.0	32.0	19	13
112015	N 99	12	R 3/8	11.5	25.5	34.5	22	15
112016	N 101	10	R 1/2	13.0	28.5	34.0	19	15
112017	N 102	12	R 1/2	13.0	28.5	34.5	22	15
112018	N 103	15	R 1/2	14.0	30.0	38.0	27	17
112019	N 104	18	R 1/2	14.0	34.0	44.0	32	22

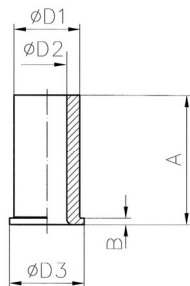

VH 8

Tube inserts (brass with a bare metal surface)

Art. No.	Type No.	Tube O.D. mm	D1 mm	D2 mm	D3 mm	A mm	B mm
112020	VH 2	4x2	2.0	1.3	3.5	8.0	0.3
112021	VH 4	6x4	4.0	3.5	5.0	10.0	0.4
112022	VH 6	8x6	6.0	5.5	8.0	15.0	0.5
112023	VH 8	10x8	8.0	7.0	10.0	15.0	0.5
112024	VH 9	12x9	9.0	8.0	12.0	15.0	0.5
112025	VH 10	12x10	10.0	9.0	12.0	15.0	0.5
112026	VH 12	15x12	12.0	11.0	15.0	15.0	0.5
112027	VH 14	18x14	14.0	13.0	17.0	18.0	0.6

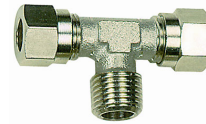
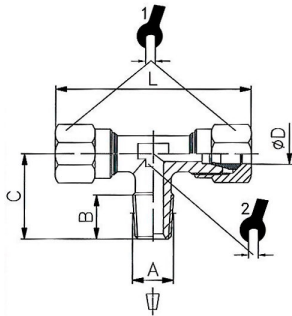

N 117

Male branch tees, conical male thread acc. to ISO 7-1

Art. No.	Type No.	ØD mm	Thread A	B mm	C mm	L mm	a/f 1 mm	a/f 2 mm
112028	N 110	4	R 1/8	8.0	16.0	44.0	10	9
112029	N 112	6	R 1/8	8.0	16.0	46.0	12	9
112030	N 115	8	R 1/8	8.0	17.0	48.0	14	11
112031	N 116	6	R 1/4	11.0	20.0	46.0	12	11
112032	N 117	8	R 1/4	11.0	20.0	48.0	14	11
112033	N 118	10	R 1/4	11.0	23.5	64.0	19	13
112034	N 119	8	R 3/8	11.5	24.0	54.0	14	13
112035	N 120	10	R 3/8	11.5	24.0	64.0	19	13
112036	N 121	12	R 3/8	11.5	25.5	69.0	22	15
112037	N 124	12	R 1/2	14.0	28.5	69.0	22	14
112038	N 125	15	R 1/2	14.0	30.0	76.0	27	17
112039	N 126	18	R 1/2	14.0	34.0	88.0	32	22

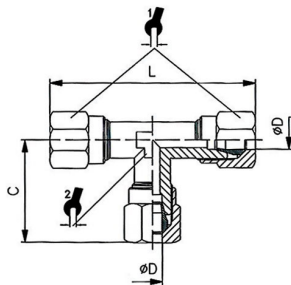

N 136

Branch tees, pipe connection on all sides

Art. No.	Type No.	ØD mm	C mm	L mm	a/f 1 mm	a/f 2 mm
112040	N 130	4	21.0	44.0	10	9
112041	N 135	6	23.0	46.0	12	9
112042	N 136	8	24.0	48.0	14	11
112043	N 137	10	32.0	64.0	19	13
112044	N 138	12	34.5	69.0	22	15
112045	N 139	15	38.0	76.0	27	17
112046	N 140	18	44.0	88.0	32	22

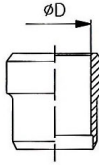

N 353

Ferrules (brass with a bare metal surface)

Art. No.	Type No.	ØD mm
112047	N 350	4
112048	N 352	6
112049	N 353	8
112050	N 362	10
112051	N 363	12
112052	N 364	15
112053	N 365	18

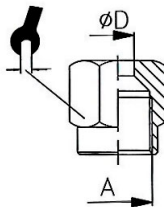

N 403

Swivel nuts

Art. No.	Type No.	ØD mm	A mm	a/f mm
112054	N 400	4	M8x1.0	10
112055	N 402	6	M10x1.0	12
112056	N 403	8	M12x1.0	14
112057	N 407	10	M16x1.5	19
112058	N 408	12	M18x1.5	22
112059	N 409	15	M22x1.5	27
112060	N 410	18	M26x1.5	32