

### Elbows

Stainless steel 1.4408

Max. operating pressure      max. 20 bar  
Max. operating temperature    max. 175 °C

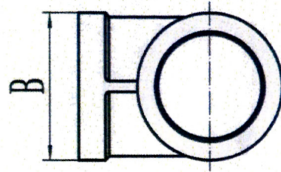
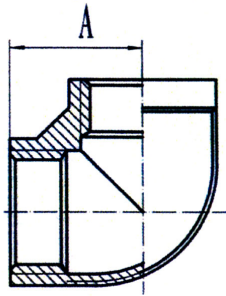

253.13-ES

**90° elbow**, female-female, Rp thread acc. to ISO 7-1

Art. No.	Type No.	Thread	A mm	B mm
112666	253.11-ES	Rp 1/8	16.4	16.4
112667	253.12-ES	Rp 1/4	19.2	20.0
112668	253.13-ES	Rp 3/8	22.5	23.5
112669	253.21-ES	Rp 1/2	27.4	27.4
112670	253.22-ES	Rp 3/4	31.1	32.2
112671	253.23-ES	Rp 1	36.9	40.0

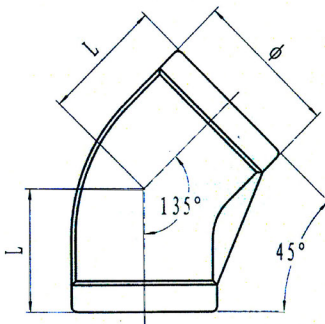

253.46-ES

**45° elbow**, female-female, Rp thread acc. to ISO 7-1

Art. No.	Type No.	Thread	L mm	Ø mm
112672	253.41-ES	Rp 1/8	15.6	16.5
112673	253.42-ES	Rp 1/4	15.9	19.9
112674	253.43-ES	Rp 3/8	17.6	23.5
112675	253.44-ES	Rp 1/2	19.2	27.6
112676	253.45-ES	Rp 3/4	22.8	32.5
112677	253.46-ES	Rp 1	26.7	40.0

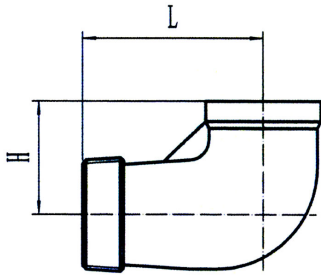

253.18-ES

90° elbow, female-male, female thread: Rp thread acc. to ISO 7-1, male thread: R thread acc. to ISO 7-1

Art. No.	Type No.	Female Thread	Male Thread	H mm	L mm
112678	253.15-ES	Rp 1/8	R 1/8	17.0	24.0
112679	253.16-ES	Rp 1/4	R 1/4	20.0	28.0
112680	253.17-ES	Rp 3/8	R 3/8	22.0	32.0
112681	253.18-ES	Rp 1/2	R 1/2	27.0	38.0
112682	253.19-ES	Rp 3/4	R 3/4	32.0	45.0
112683	253.20-ES	Rp 1	R 1	37.0	52.0

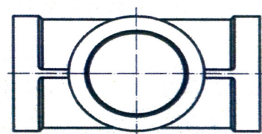
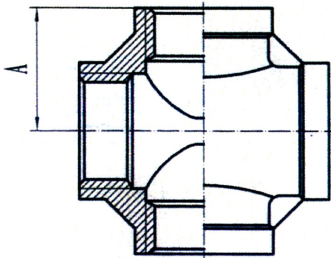

253.66-ES

X-distributor, 4 x female, Rp thread acc. to ISO 7-1

Art. No.	Type No.	Thread	A mm
112684	253.61-ES	Rp 1/8	19.0
112685	253.62-ES	Rp 1/4	19.0
112686	253.63-ES	Rp 3/8	23.0
112687	253.64-ES	Rp 1/2	27.0
112688	253.65-ES	Rp 3/4	32.0
112689	253.66-ES	Rp 1	38.0

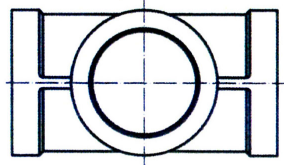
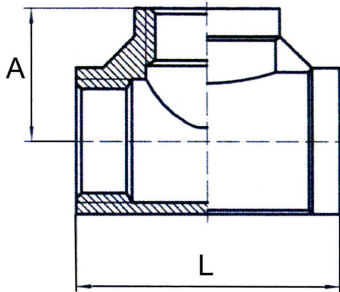

254.36-ES

**Tee distributor, 3 x female, Rp thread acc. To ISO 7-1**

Art. No.	Type No.	Thread	L mm	A mm
112690	254.33-ES	Rp 1/8	34.0	17.0
112691	254.34-ES	Rp 1/4	38.0	19.0
112692	254.35-ES	Rp 3/8	46.1	22.0
112693	254.36-ES	Rp 1/2	54.0	27.0
112694	254.37-ES	Rp 3/4	63.0	32.0
112695	254.38-ES	Rp 1	73.0	36.0