

## Swing Bolts similar to DIN 444, black oxide finished Steel and Stainless Steel

Material: Steel, black oxide finish, tensile strength 5.8.

Material: Stainless steel 1.4305.



Precision made, thread rolled.

Contrary to the standards sheet the black oxide finished steel version has a higher tensile strength (5.8 instead of 4.6 / 5.6) and the thread length  $l_2$  is larger at both versions.

The stainless steel version is not part of the DIN.

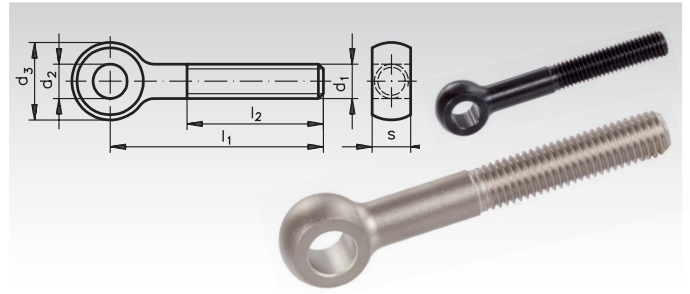

Ordering Details: e.g.: Product No. 654 406 00, Swing Bolt DIN 444, M6

Product No. Steel 5.8	Product No. stainless	d <sub>1</sub> mm	l <sub>1</sub> mm	l <sub>2</sub> mm	d <sub>2</sub> <sup>H7</sup> mm	d <sub>3</sub> mm	s <sup>0,2</sup> mm	Weight g
654 404 00	654 994 04	M5	50	32	5	12	6	9
654 405 00	654 994 05	M5	75	32	5	12	6	13
654 406 00	654 994 06	M6	50	32	6	14	7	14
654 407 00	654 994 07	M6	75	32	6	14	7	20
654 410 00	654 994 10	M8	50	32	8	18	9	26
654 411 00	654 994 11	M8	75	32	8	18	9	36
654 414 00	654 994 14	M10	50	40	10	20	12	38
654 415 00	654 994 15	M10	75	40	10	20	12	52
654 416 00	654 994 16	M10	100	40	10	20	12	68
654 418 00	654 994 18	M12	75	40	12	25	14	80
654 420 00	654 994 20	M12	100	40	12	25	14	98
654 421 00	654 994 21	M12	130	40	12	25	14	120
654 424 00	654 994 24	M16	75	50	16	32	17	146
654 425 00	654 994 25	M16	100	50	16	32	17	183
654 426 00	654 994 26	M16	130	50	16	32	17	220
654 428 00	654 994 28	M20	100	63	18	40	22	305
654 429 00	654 994 29	M20	130	63	18	40	22	366
654 430 00	654 994 30	M20	160	63	18	40	22	438

## Spherical Washers DIN 6319

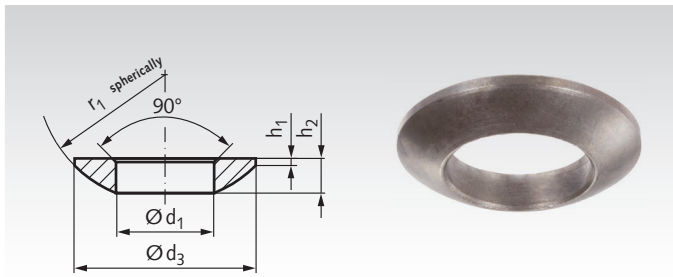

Material: Steel, bright, turned, case hardened, hardening depth min. 0.2 mm.

Ordering Details: e.g.: Product No. 655 406 00, Spherical Washer DIN 6319, 6.4 mm

Product No. Type C	d <sub>1</sub> <sup>H13</sup> mm	d <sub>3</sub> mm	h <sub>1</sub> mm	h <sub>2</sub> mm	r <sub>1</sub> mm	for bolt mm	F* kN	Weight g
655 406 00	6,4	12	0,7	2,3	9	M6	9	0,9
655 408 00	8,4	17	0,6	3,2	12	M8	17	2,5
655 410 00	10,5	21	0,8	4,0	15	M10	26	4,7
655 412 00	13	24	1,1	4,6	17	M12	38	7,1
655 414 00	15	28	1,2	5,0	22	M14	53	10,0
655 416 00	17	30	1,3	5,3	22	M16	73	12,3
655 420 00	21	36	2,0	6,3	27	M20	117	21
655 424 00	25	44	2,4	8,2	32	M24	168	42
655 430 00	31	56	3,6	11,2	41	M30	269	87
655 436 00	37	68	4,6	14,0	50	M36	394	184
655 440 00	43	78	6,5	17,0	58	M42	542	297
655 448 00	50	92	8,0	21,0	67	M48	714	525

\* Max. statical load.

## Conical Seats DIN 6319

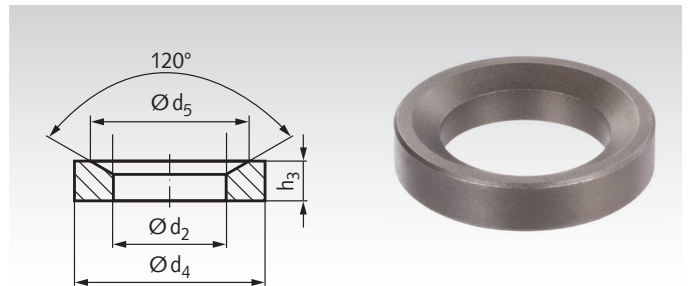

Material: Steel, bright, turned, case hardened, hardening depth min. 0.2 mm.

Ordering Details: e.g.: Product No. 655 506 00, Conical Seat DIN 6319, 7.1 mm

Product No. Type D	d <sub>2</sub> <sup>H13</sup> mm	d <sub>4</sub> mm	d <sub>5</sub> mm	h <sub>3</sub> mm	h <sub>4</sub> ** mm	for bolt mm	F* kN	Weight g
655 506 00	7,1	12	11,0	2,8	4,2	M6	9	1,4
655 508 00	9,6	17	14,5	3,5	5,6	M8	17	3,8
655 510 00	12	21	18,5	4,2	6,5	M10	26	6,5
655 512 00	14,2	24	20,0	5,0	8,0	M12	38	10,6
655 514 00	16,5	28	24,8	5,6	8,5	M14	53	18,0
655 516 00	19	30	26	6,2	9,6	M16	73	18,7
655 520 00	23,2	36	31	7,5	11,7	M20	117	32
655 524 00	28	44	37	9,5	15,2	M24	168	63
655 530 00	35	56	49	12,0	19,2	M30	269	133
655 536 00	42	68	60	15,0	23,5	M36	394	236
655 540 00	49	78	70	18,0	29,0	M42	542	365
655 548 00	56	92	82	22,0	35,5	M48	714	641

\* Max. statical load.

\*\* Total height, together with spherical washer.