

Revolving Cylindrical Handles 598

Material:
Version K: Duroplast PF31, black, glossy finish.
 Spindle: Steel, zinc-plated.
Version N: Duroplast PF31, black, glossy finish.
 Spindle: Stainless steel 1.4305.

Modern design.

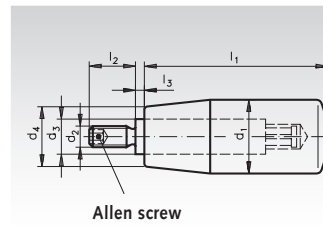

Ordering Details: e.g.: Product No. 663 418 00, Handle 598, Version K, 18 mm

Product No. Vers. K	Product No. Vers. N	d ₁ mm	d ₂ mm	d ₃ mm	d ₄ mm	l ₁ mm	l ₂ mm	l ₃ mm	Weight in g	
									Vers. K	Vers. N
663 418 00	663 518 00	18	M6	10	15	40	12	2,5	29	29
663 421 00	663 521 00	21	M6	10	17	50	13	2,5	42	42
663 422 00	-	22	M6	10	18	56	13	2,5	47	-
663 423 00	663 523 00	23	M8	13	19	65	14	2,5	79	79
663 426 00	663 526 00	26	M10	13	21	80	16	2,5	109	109
663 428 00	663 528 00	28	M10	13	22	90	16	2,5	125	125
663 431 00	663 531 00	31	M12	14	25	102	20	2,5	175	175

Retractable Handles NG

Material:
Version K: Duroplast PF31, black, glossy finish.
 Folding mechanism: Steel, black oxide finish.
Version N: Duroplast PF31, black, glossy finish.
 Folding mechanism: Stainless steel 1.4305.



Use: When the handle must at times not stick out. The handle is pulled out of its taper seating and then tilted. A compression spring locks the handle in both end positions. All handles are revolving (type 598).

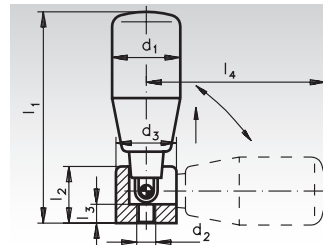

Ordering Details: e.g.: Product No. 663 200 00, Retractable Handle NG, Version K, 21 mm

Product No. Vers. K	Product No. Vers. N	d ₁ mm	d ₂ mm	d ₃ mm	l ₁ mm	l ₂ mm	l _{3-0,5} mm	l ₄ mm	Weight g
663 200 00	-	21	M5	16	67	15,0	5	62	58
663 201 00	663 992 01	26	M6	20	102	19,5	6	95	134
663 202 00	663 992 02	28	M8	26	118	26,0	10	106	214

Cylindrical Knobs, Press-On Type

Material: Thermoplast (Polypropylene PP), impact resistant, black, matt finish.

These knobs do not require a thread at the shaft.

During mounting, easy blows with a soft hammer are sufficient to drive the knob into place. The shaft end with tolerance h9 should be slightly rounded or chamfered (30°). The knob is quickly mounted and sits absolute vibration-tight.

Temperature resistant up to 80°C.

Ordering Details: e.g.: Product No. 662 201 18, Cylindrical Knob, 18 mm

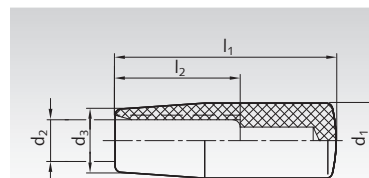

Product No.	d ₁ mm	d ₂ mm	d ₃ mm	l ₁ mm	l ₂ min. mm	Weight g
662 202 18	18	8	15	40	28	7
662 202 21	21	10	17	50	35	10
662 202 23	23	10	19	65	45	17
662 202 26	26	12	21	80	50	25
662 202 28	28	15	22	90	60	33